

NO PART OF THIS DOCUMENT MAY BE REPRODUCED WITHOUT PRIOR AGREEMENT AND WRITTEN PERMISSION OF
FORD PERFORMANCE PARTS

PRIOR TO INSTALLATION READ THESE INSTRUCTION COMPLETELY
For questions, Call the FORD PERFORMANCE Techline 1-800-367-3788

Please visit <https://www.performanceparts.ford.com> for warranty information

Warn Winch Kit

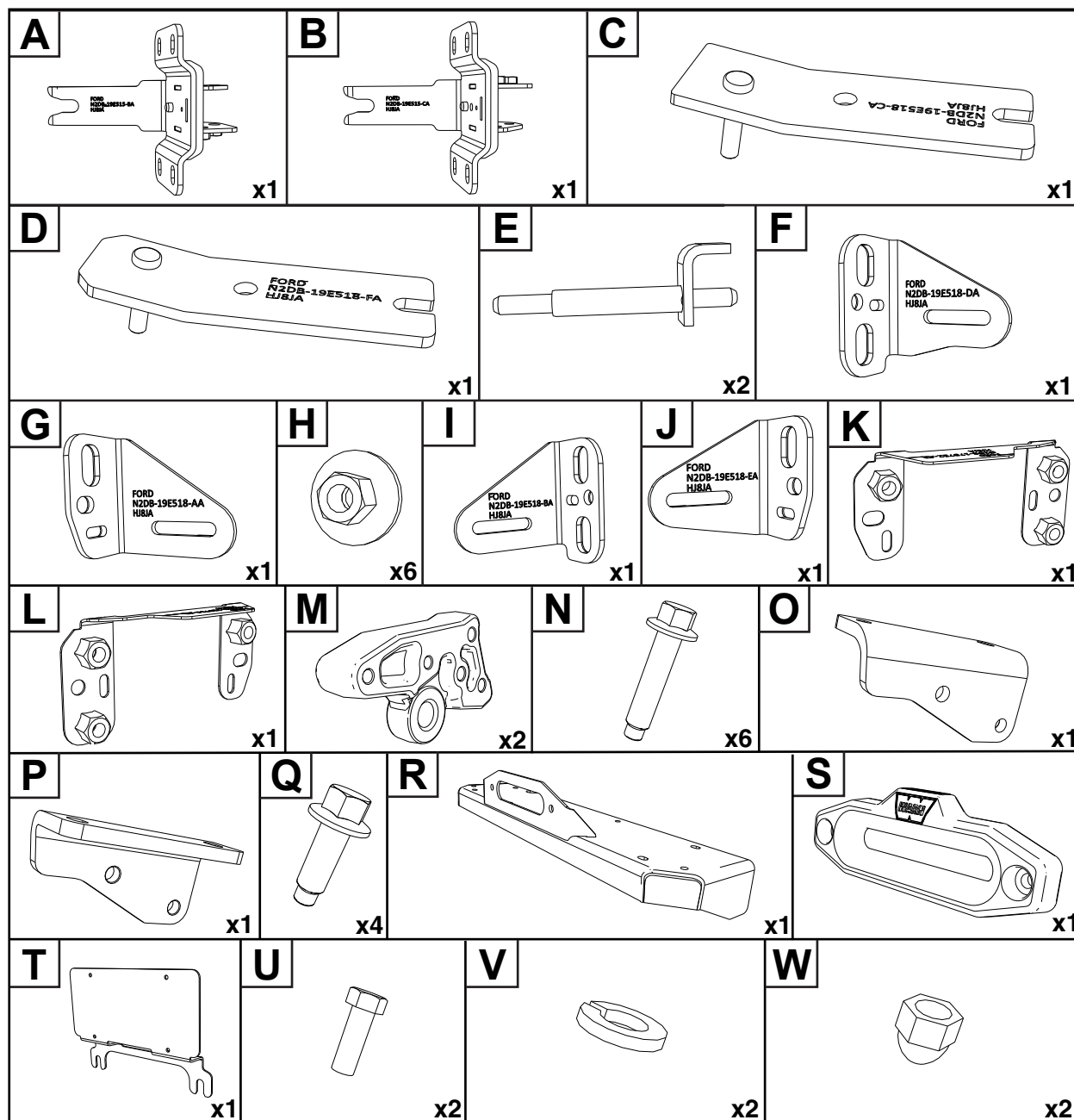

Ford Factory Shop Manual purchase options www.motorcraftservice.com

NO PART OF THIS DOCUMENT MAY BE REPRODUCED WITHOUT PRIOR AGREEMENT AND WRITTEN PERMISSION OF
FORD PERFORMANCE PARTS

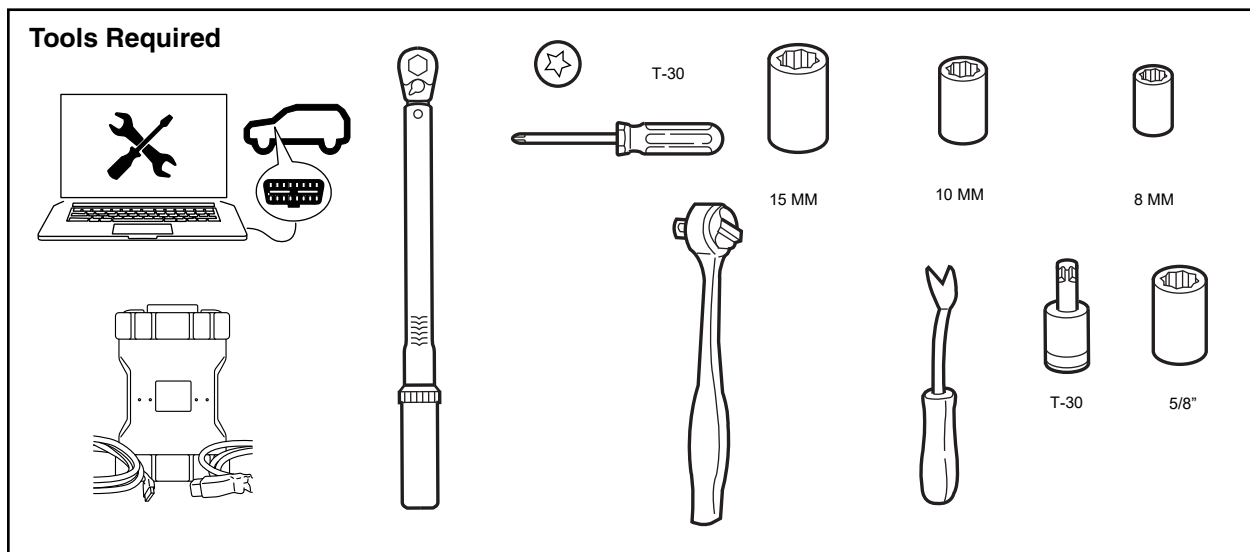
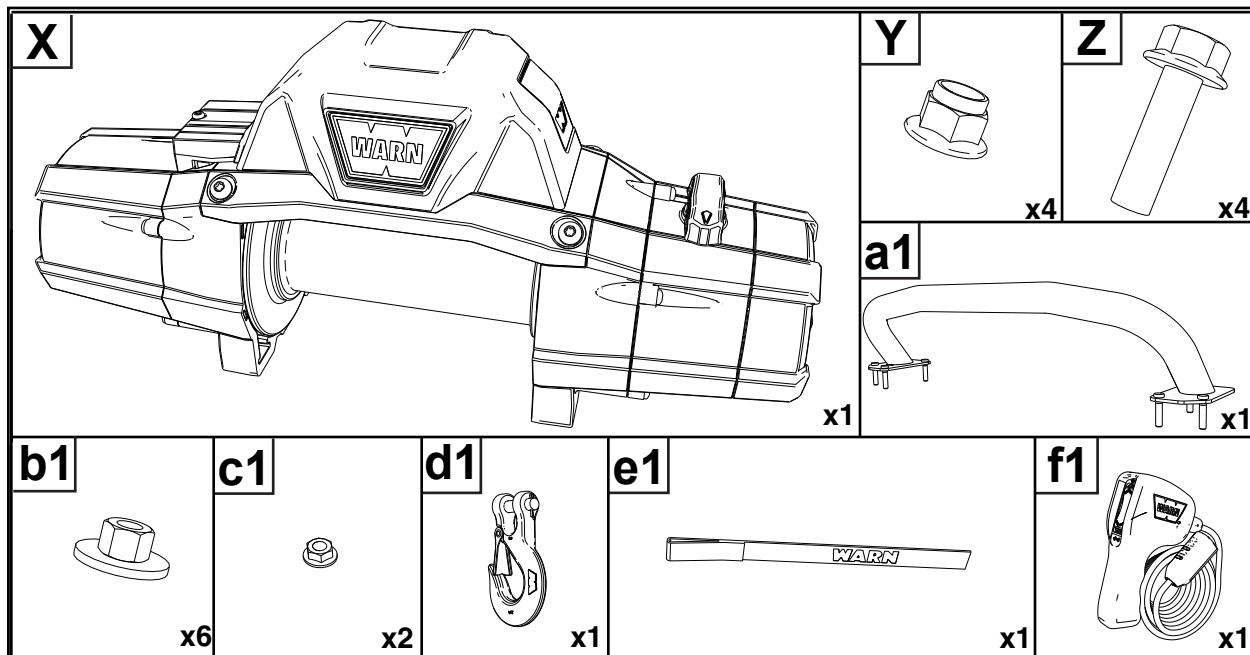



M-1821-B
2021 →
Bronco Off-Road Winch

NO PART OF THIS DOCUMENT MAY BE REPRODUCED WITHOUT PRIOR AGREEMENT AND WRITTEN PERMISSION OF
FORD PERFORMANCE PARTS

Kit Contents	Description	Part Number
A	Clevis Bracket (Left Hand)	N2DB-19E515-BA
B	Clevis Bracket (Right Hand)	N2DB-19E515-CA
C	CAC Bracket (Left Hand)	N2DB-19E518-CA
D	CAC Bracket (Right Hand)	N2DB-19E518-FA
E	Inner Frame Bolt	N2DB-19H381-AA
F	Inner Frame Bracket (Right Hand)	N2DB-19E518-DA
G	Outer Frame Bracket (Left Hand)	N2DB-19E518-AA
H	Frame Bracket Nut - M10 HX PTM FL 10	W716805-S442
I	Inner Frame Bracket (Left Hand)	N2DB-19E518-BA
J	Outer Frame Bracket (Right Hand)	N2DB-19E518-EA
K	Frame Nut Plate (Left Hand)	N2DB-17B757-AA
L	Frame Nut Plate (Right Hand)	N2DB-17B756-AA
M	Recovery Forging	N2DB-19E515-AA
N	Outer Frame Bolt - M12x1.75x80.0 HEX FLNG PIL	W500747-S450B
O	Recovery Forging Bracket (Left Hand)	N2DB-19H292-BA
P	Recovery Forging Bracket (Right Hand)	N2DB-19H292-CA
Q	Recovery Forging Bracket Bolt - M12X30 HF PIL 10	W500642-S405B
R	Winch Plate	N2DB-19H292-AA
S	Fair Lead	N2DB-19E514-AA
T	License Plate Kit (Optional)	KN2DB-17N397-AA
U	Fairlead Bolt - 7/16-14 HX	WARN-1824
V	Fairlead Washer - 7/16 HELIX SPLIT	WARN-2146
W	Fairlead Nut - 7/16 ACORN	WARN-73849
X	Winch	N2DB-19E513-AA
Y	Winch Housing Nut - M10	WARN-87166
Z	Winch Housing Bolt - M10 X 35	WARN-69954
a1	Brush Bar	
b1	Brush Bar Nut - M10 HX PTM FL 10	W716805-S450B
c1	Nut - M6 HF 8	W520412-S437
d1	Hook	N2DB-19H382-AA
e1	Hook Strap	
f1	Winch Remote	LC3C-19H380-AA

Ford Factory Shop Manual purchase options www.motorcraftservice.com

NO PART OF THIS DOCUMENT MAY BE REPRODUCED WITHOUT PRIOR AGREEMENT AND WRITTEN PERMISSION OF FORD PERFORMANCE PARTS

INSTALLATION PROCEDURE - Winch Kit

IMPORTANT: After winch installation ensure the warning label is installed under the mounting plate. See illustration below. Restraint Control Module (RCM) programming is required after winch installation to ensure the vehicle systems function properly. Perform RCM reprogramming after the winch has been installed.

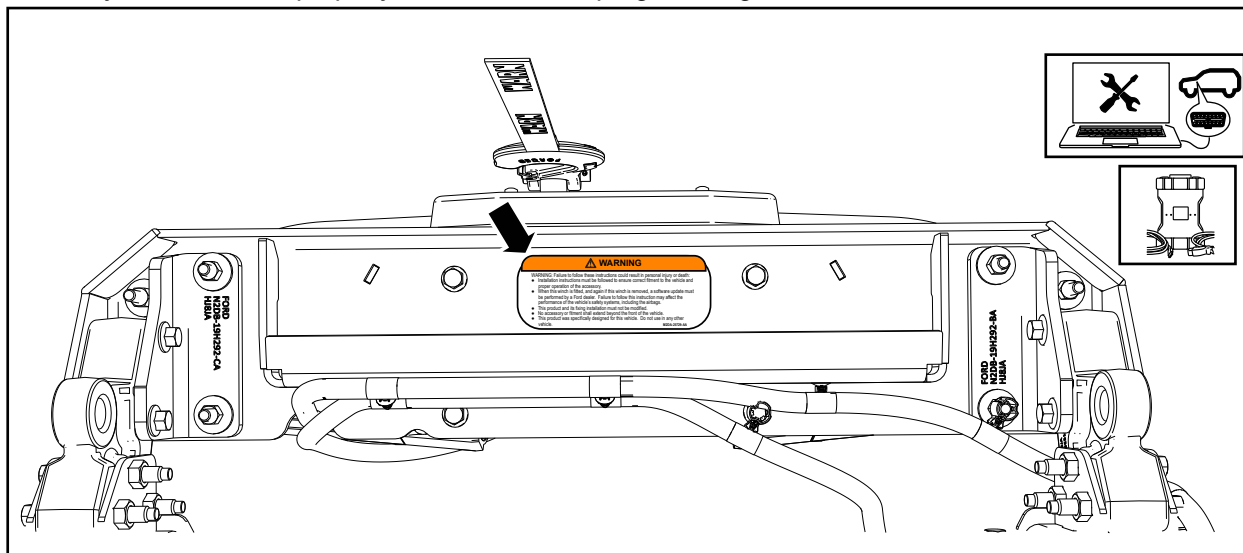

1. Remove the retainers and the skid plate.

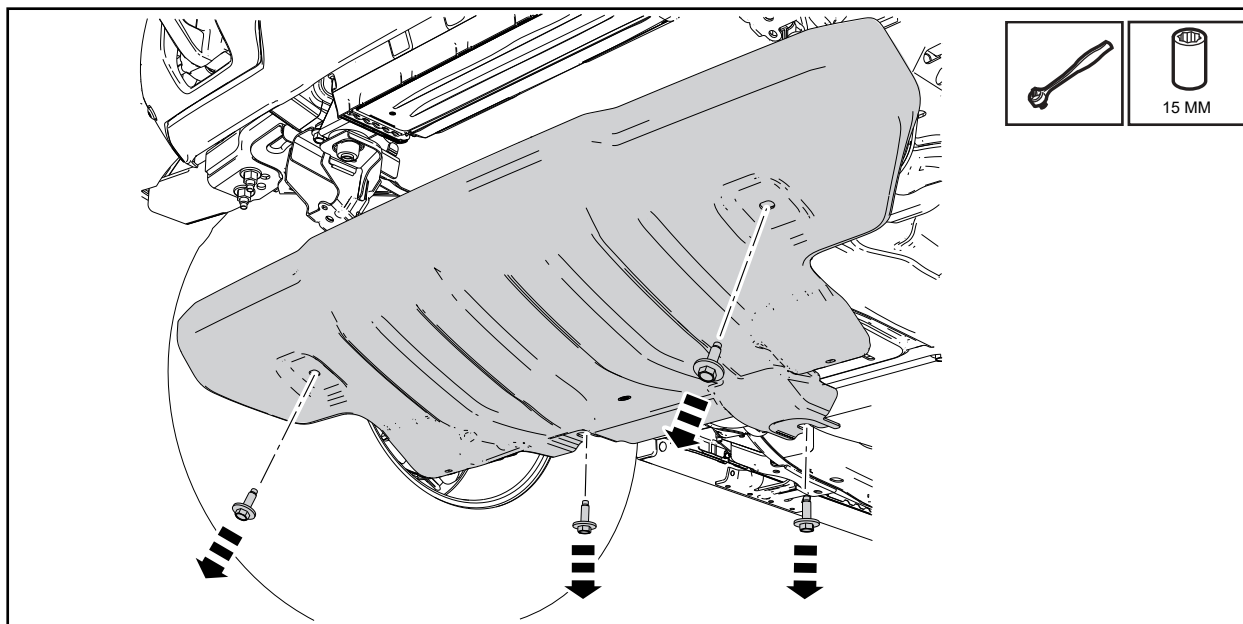

NO PART OF THIS DOCUMENT MAY BE REPRODUCED WITHOUT PRIOR AGREEMENT AND WRITTEN PERMISSION OF
FORD PERFORMANCE PARTS

2. Remove the push pin retainers.

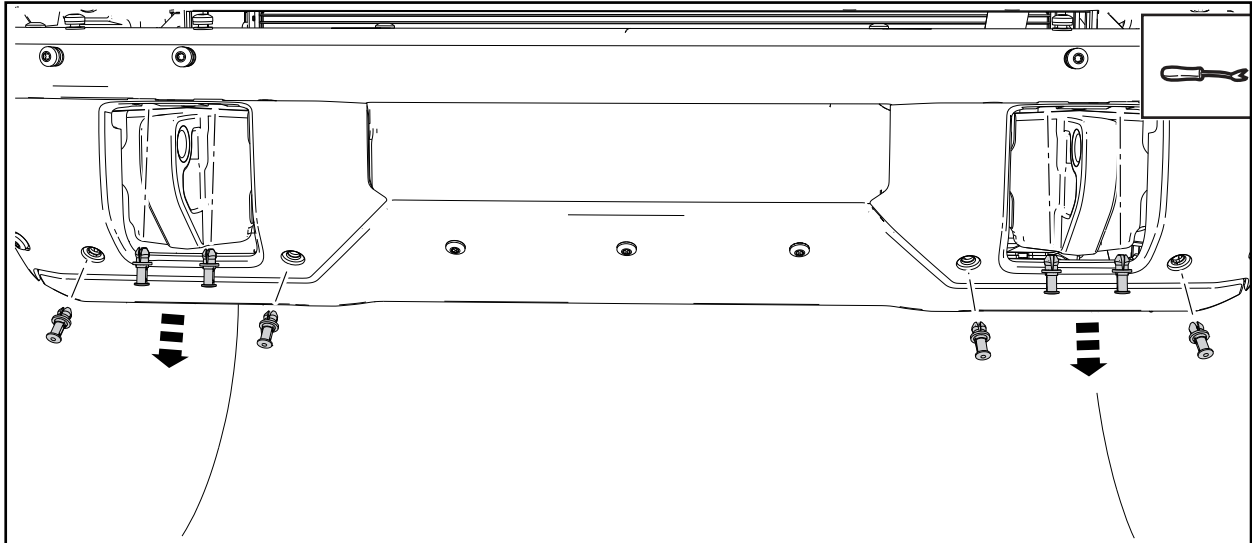

3. Remove the front bumper trim panel.

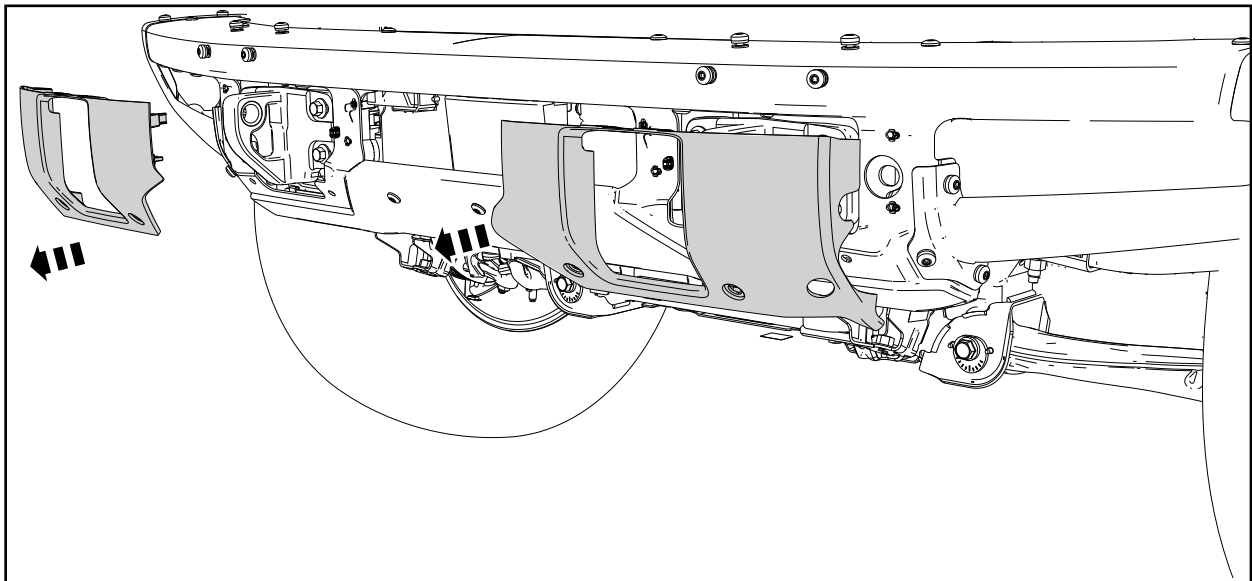

NO PART OF THIS DOCUMENT MAY BE REPRODUCED WITHOUT PRIOR AGREEMENT AND WRITTEN PERMISSION OF
FORD PERFORMANCE PARTS

4. If Equipped, remove the bolts and the safari bar.

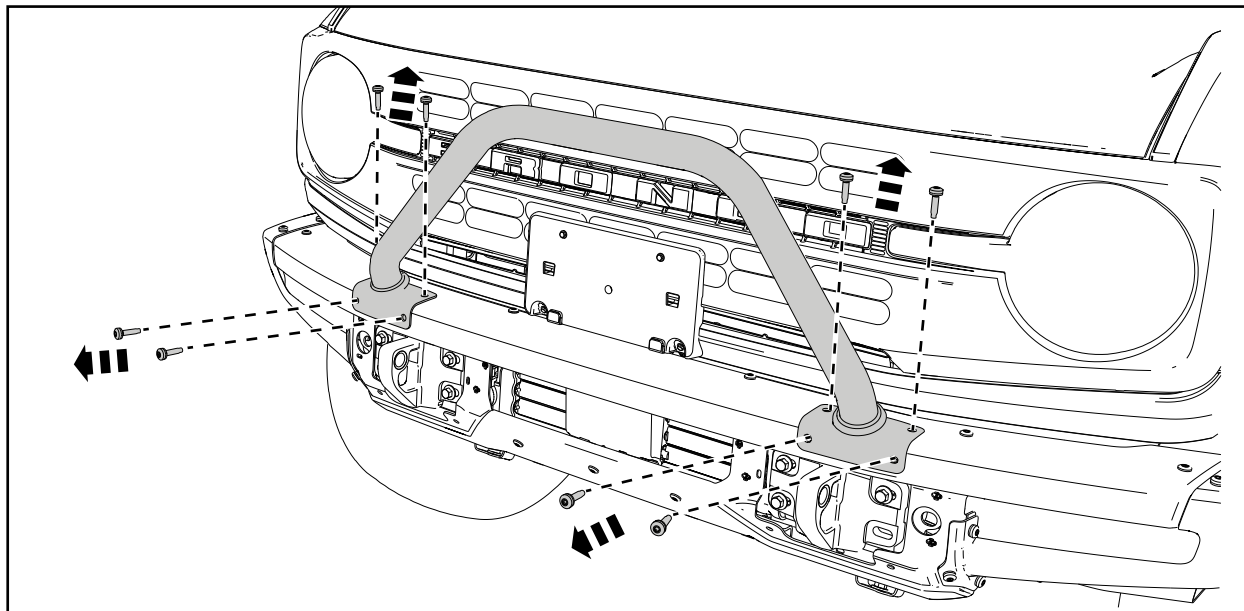

5. Install the safari bar retainers into the front bumper.

• Torque: 25 Nm (18 ft-lb)

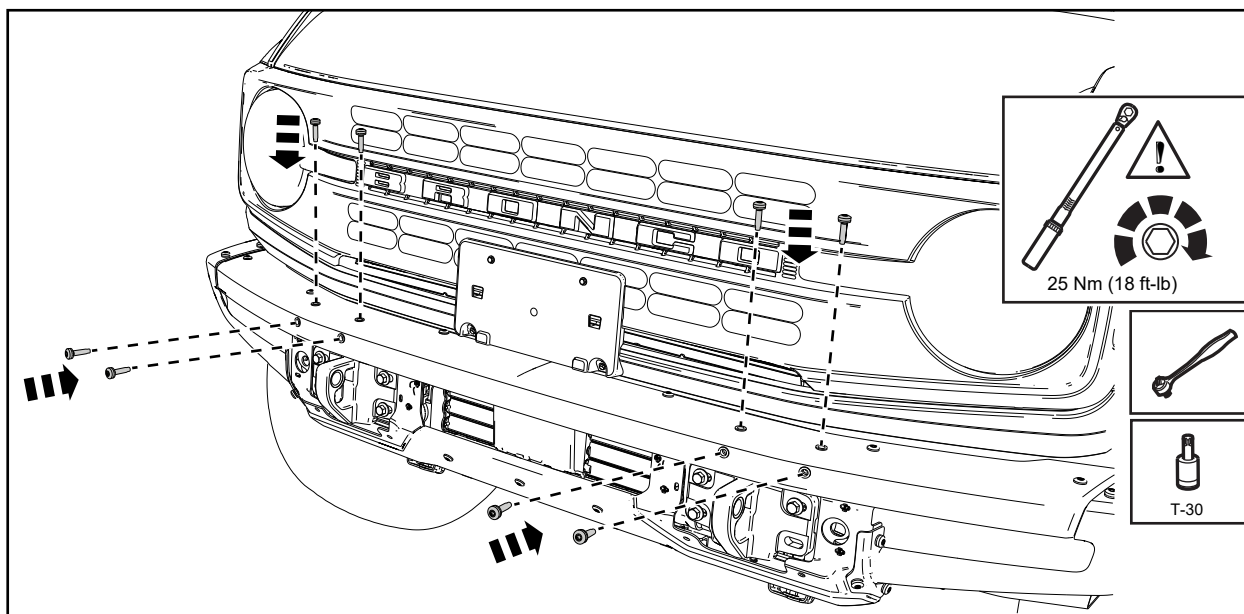

NO PART OF THIS DOCUMENT MAY BE REPRODUCED WITHOUT PRIOR AGREEMENT AND WRITTEN PERMISSION OF
FORD PERFORMANCE PARTS

NOTE: Save front bumper bolts for installation.

6. Remove the front bumper bolts.

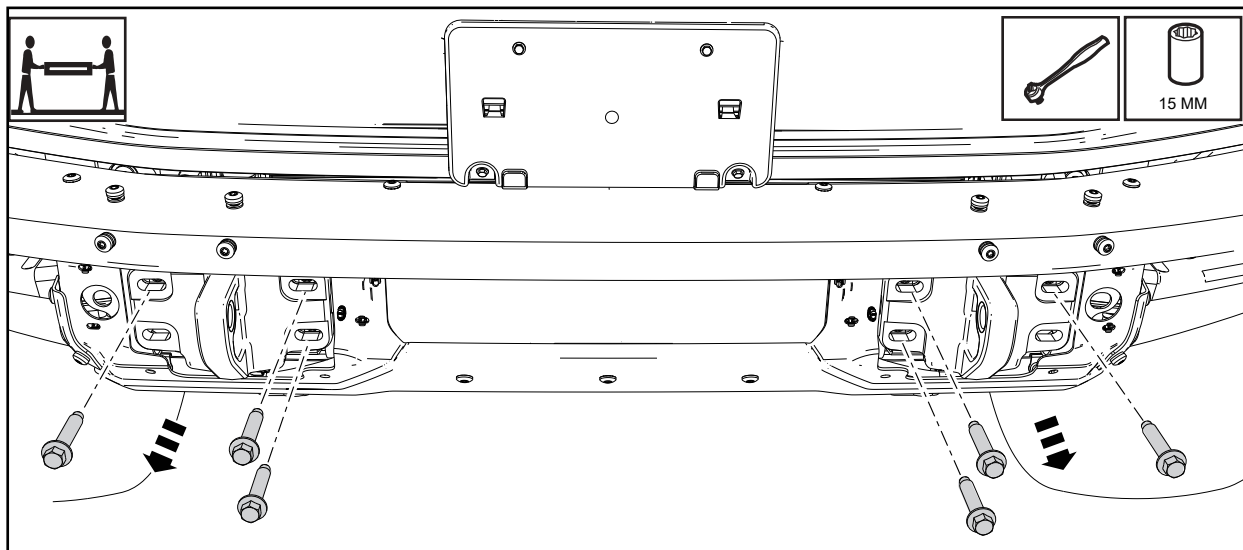

NOTE: If the bumper is equipped with a safari bar it must be removed before proceeding. The mounting bolts should be reinstalled and torqued to 18 lb.ft (25 Nm).

7. Remove the front bumper.

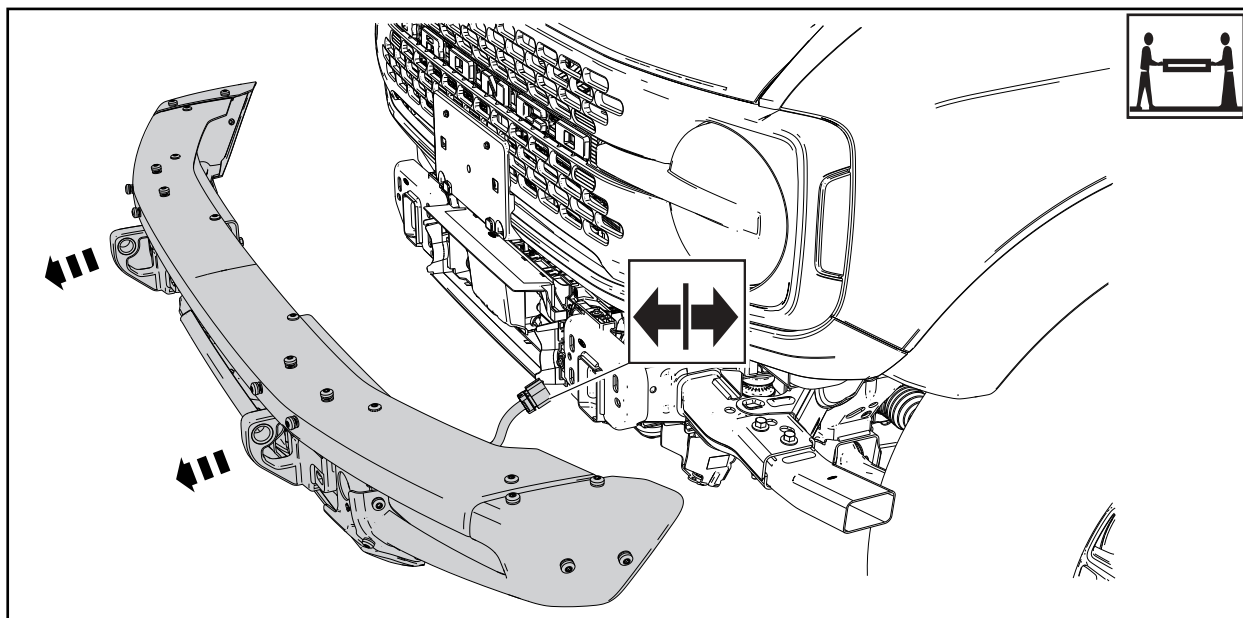

NO PART OF THIS DOCUMENT MAY BE REPRODUCED WITHOUT PRIOR AGREEMENT AND WRITTEN PERMISSION OF
FORD PERFORMANCE PARTS

8. Remove the retainers and the front license plate mounting bracket.

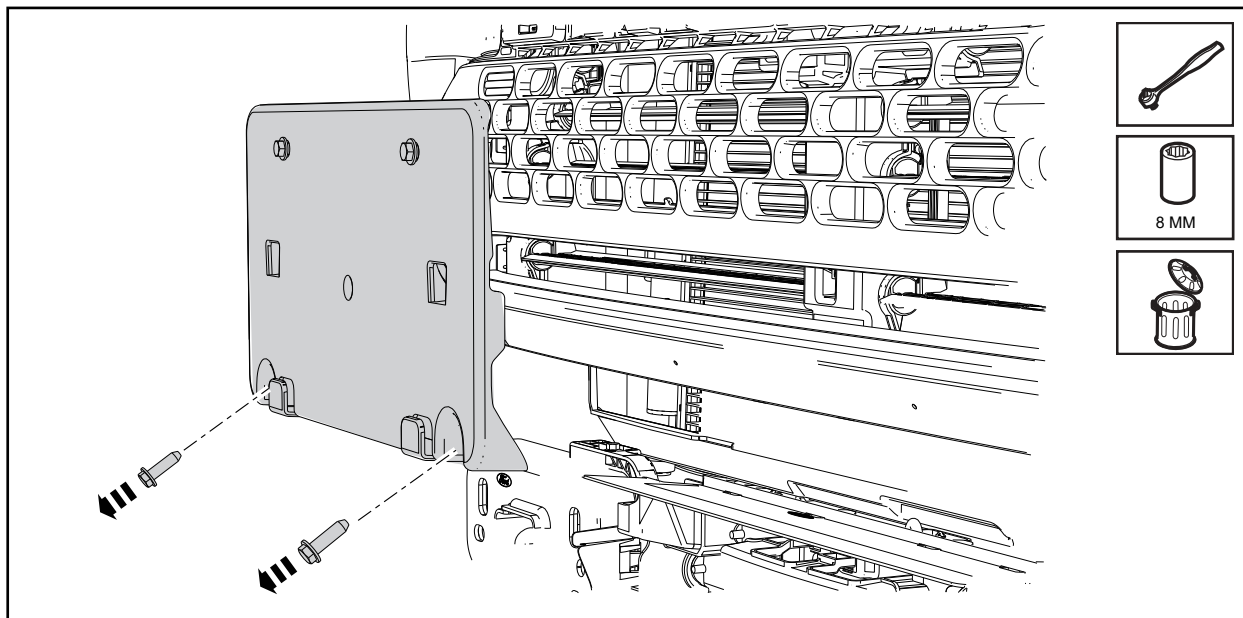

9. Remove the recovery hook holding bolts.

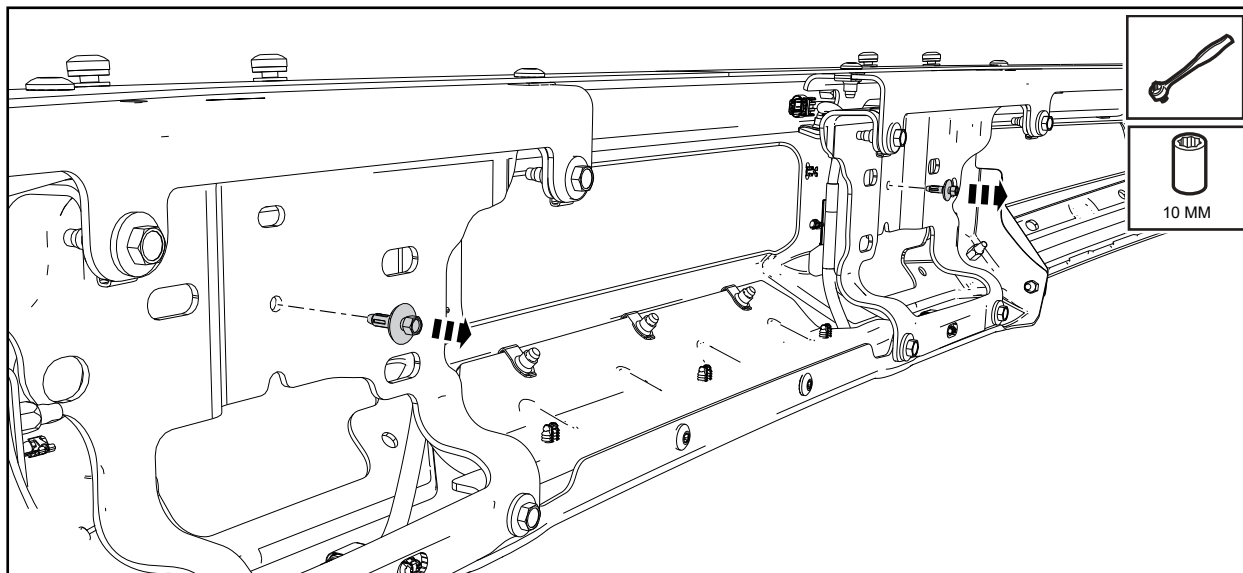

NO PART OF THIS DOCUMENT MAY BE REPRODUCED WITHOUT PRIOR AGREEMENT AND WRITTEN PERMISSION OF
FORD PERFORMANCE PARTS

10. Remove and discard the recovery hooks.

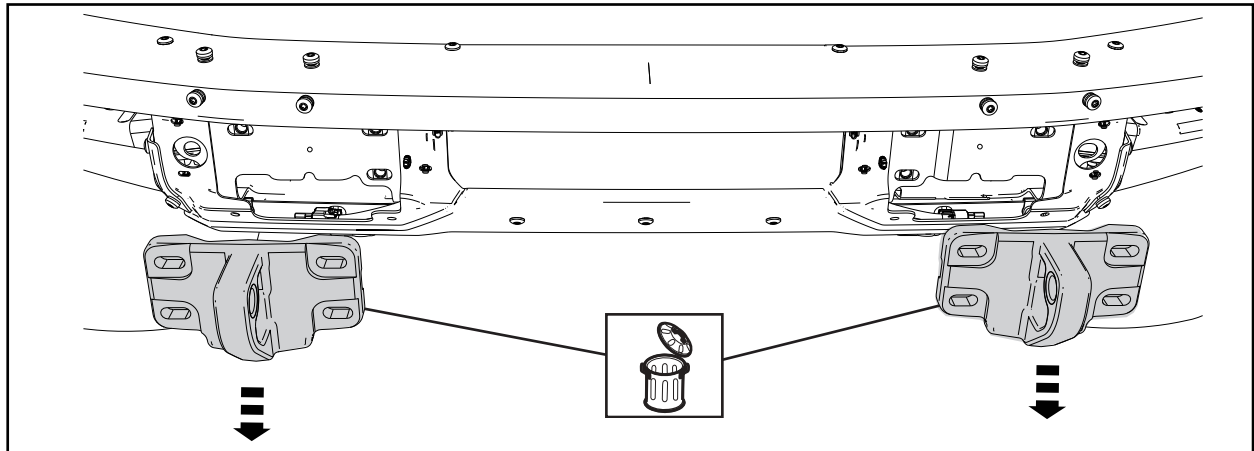

11. Remove the plastic holding nuts on both sides of the vehicle.

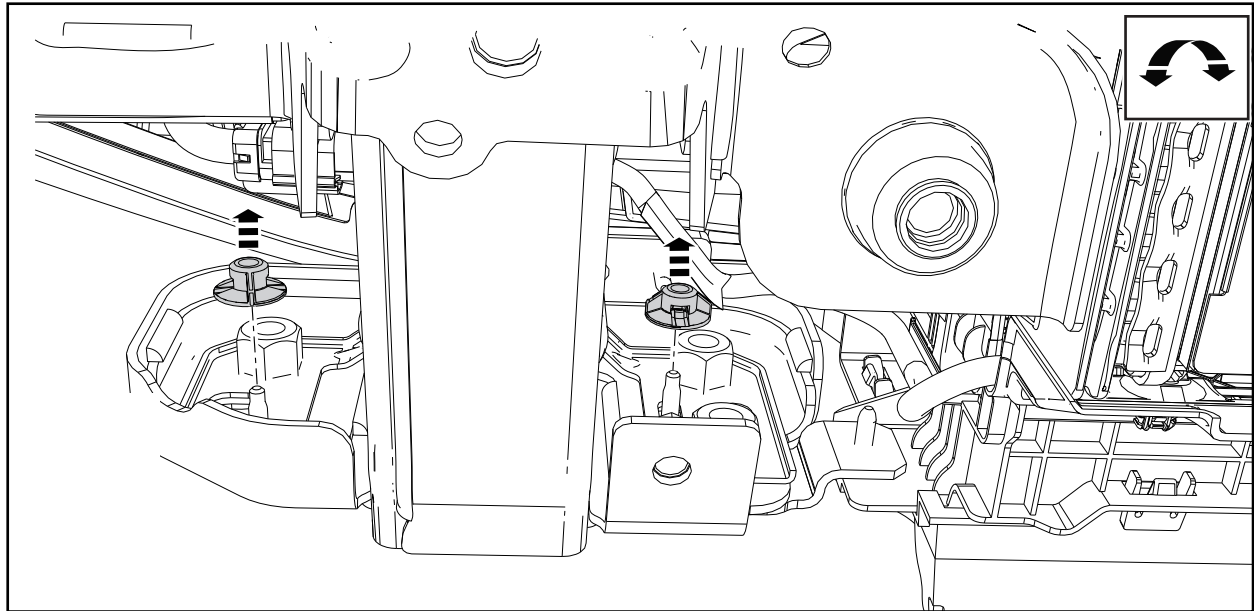

NO PART OF THIS DOCUMENT MAY BE REPRODUCED WITHOUT PRIOR AGREEMENT AND WRITTEN PERMISSION OF
FORD PERFORMANCE PARTS

12. Remove and discard the frame nut plate on both sides of the vehicle.

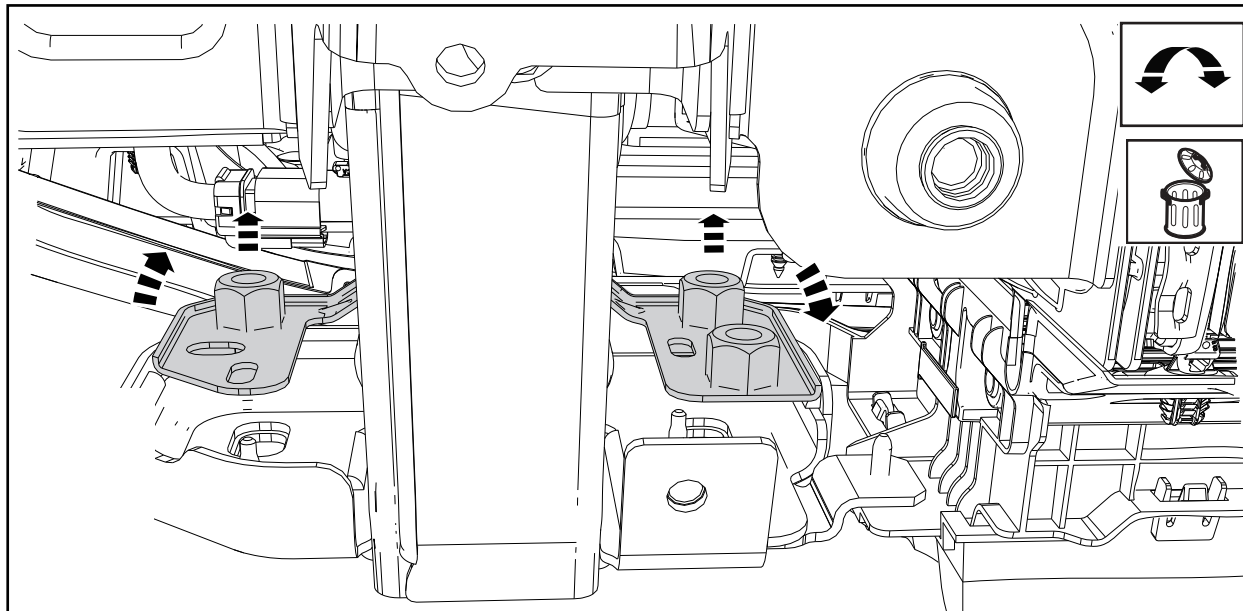

13. Install the two clevis brackets to the bumper.

• Torque: 10.5 Nm (7.5 ft-lb)

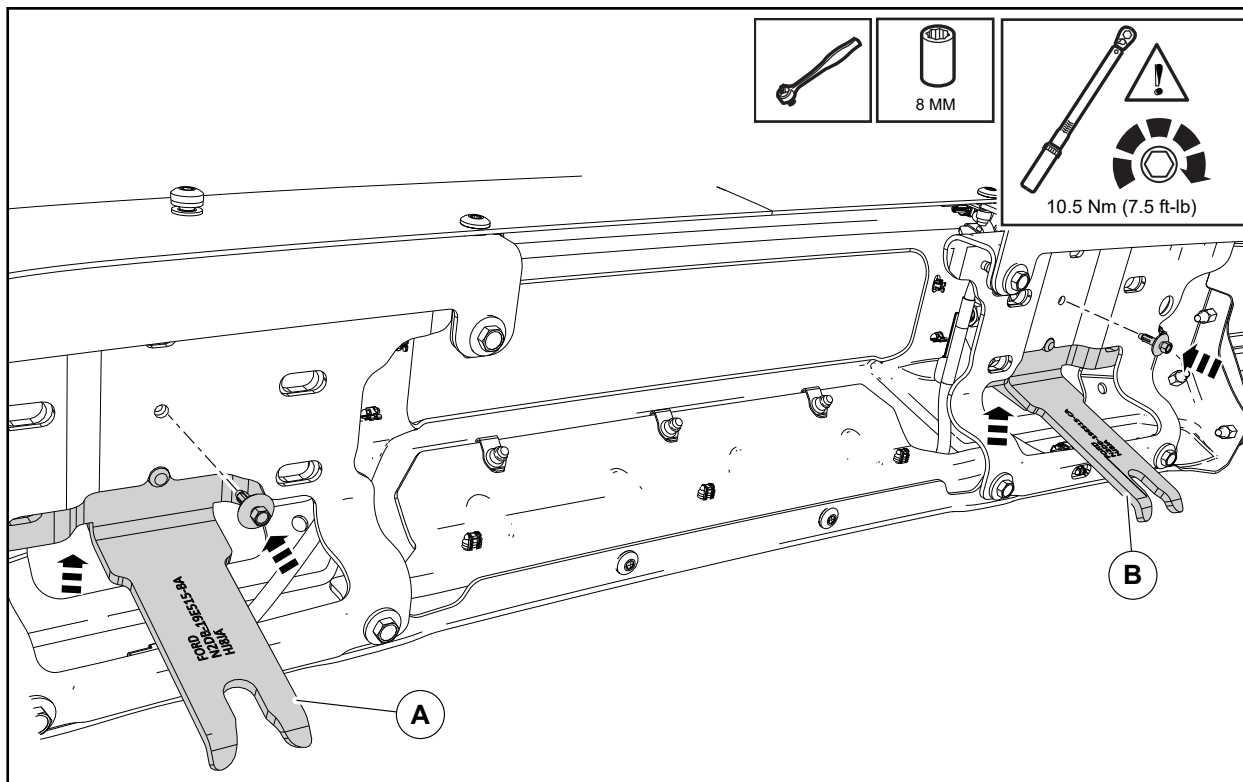

Ford Factory Shop Manual purchase options www.motorcraftservice.com

NO PART OF THIS DOCUMENT MAY BE REPRODUCED WITHOUT PRIOR AGREEMENT AND WRITTEN PERMISSION OF
FORD PERFORMANCE PARTS

NOTE: Save frame bolts for installation (*).

14. Remove the two frame bolts. Perform this step on both sides.

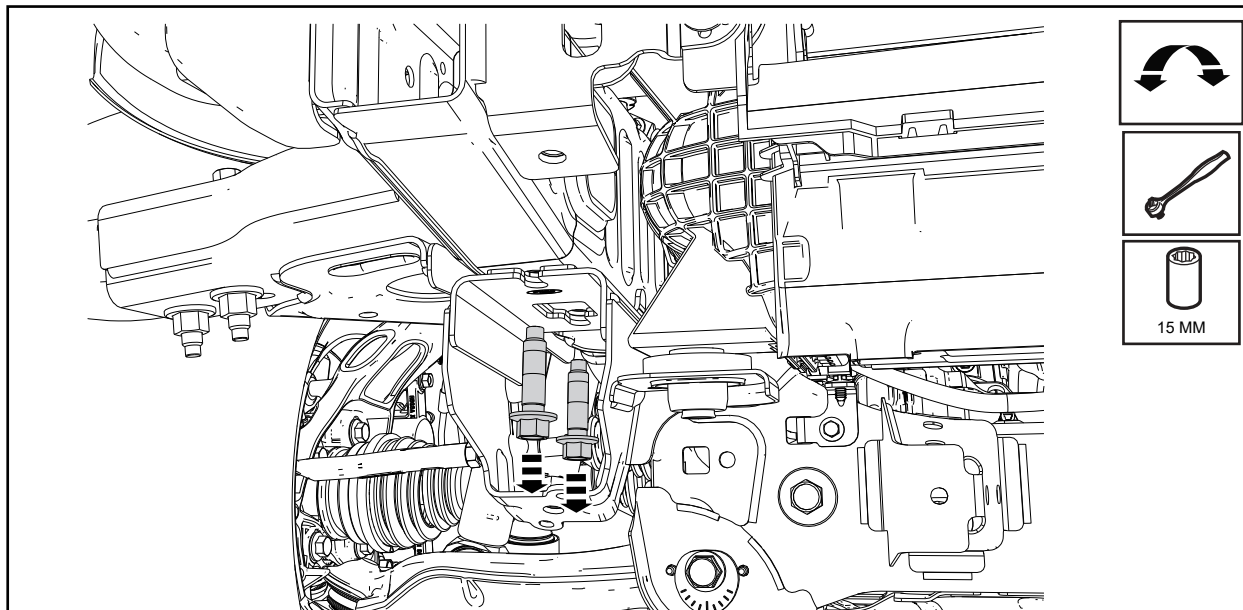

15. Install the winch CAC bracket and the bolts saved from step 14 to the frame.

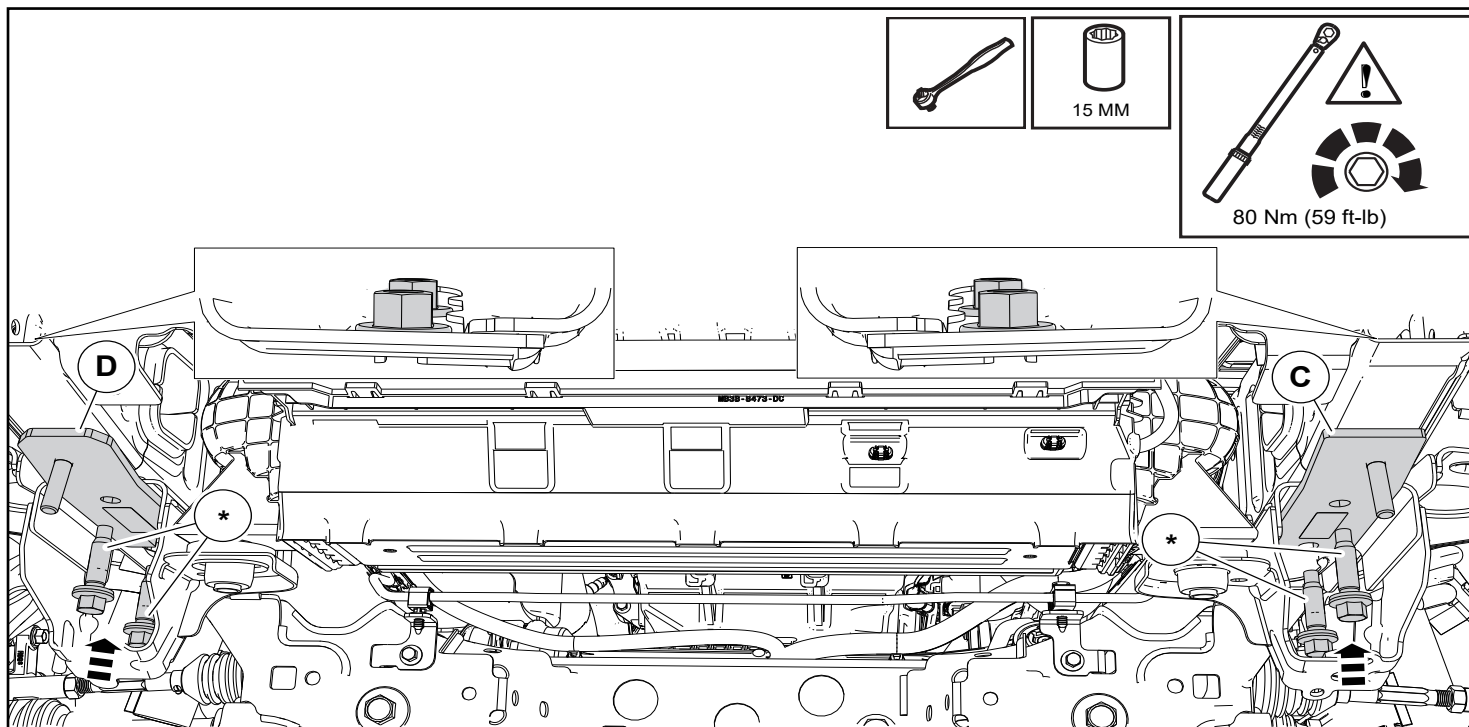

NO PART OF THIS DOCUMENT MAY BE REPRODUCED WITHOUT PRIOR AGREEMENT AND WRITTEN PERMISSION OF
FORD PERFORMANCE PARTS

16. Install the shoulder bolt into the frame rail. Perform this step on both sides of the vehicle.

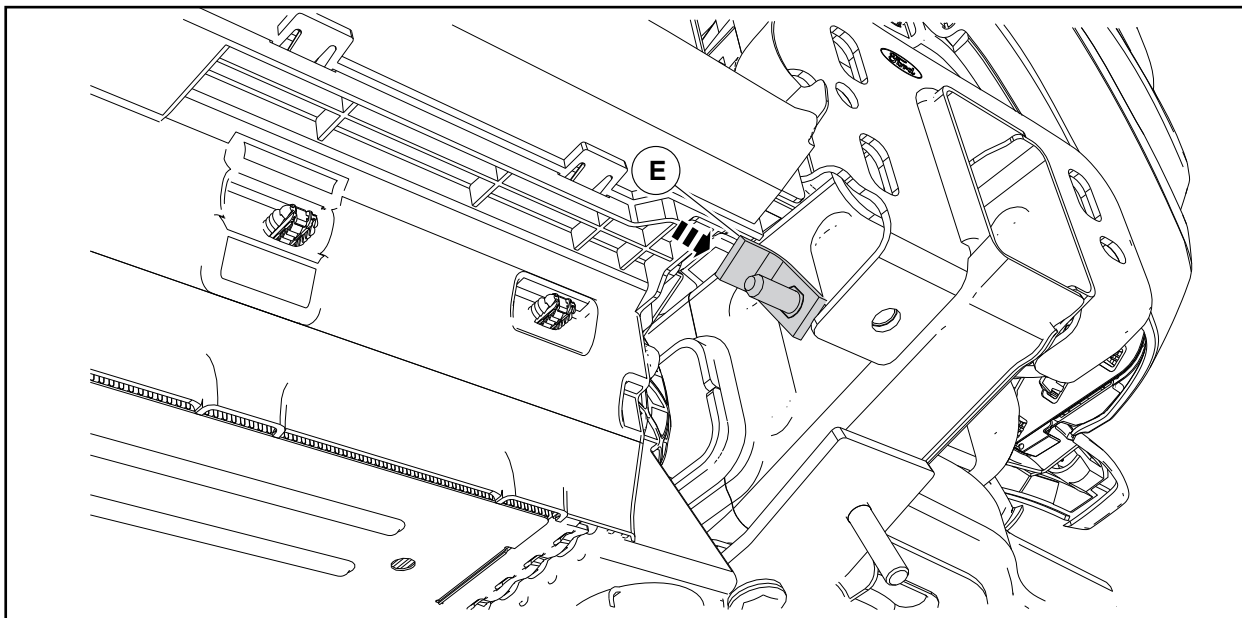

17. Install the left hand inner and outer bracket to the frame rail. Hand tighten the nuts at this time.

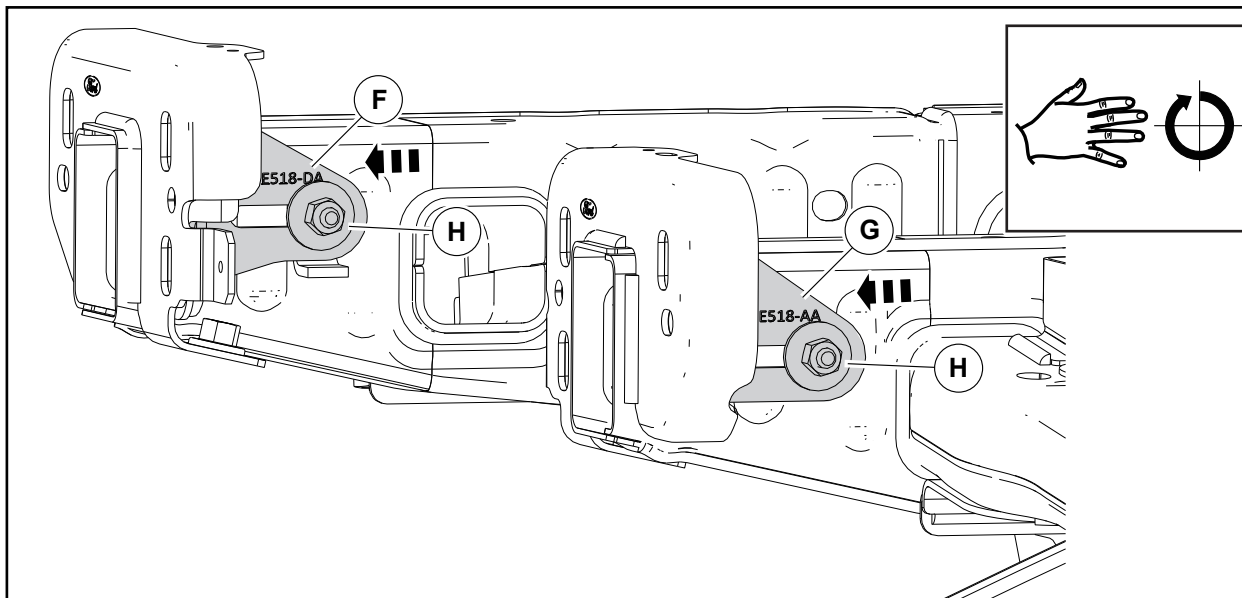

NO PART OF THIS DOCUMENT MAY BE REPRODUCED WITHOUT PRIOR AGREEMENT AND WRITTEN PERMISSION OF FORD PERFORMANCE PARTS

18. Install the right hand inner and outer bracket to the frame rail. Hand tighten the nuts at this time.

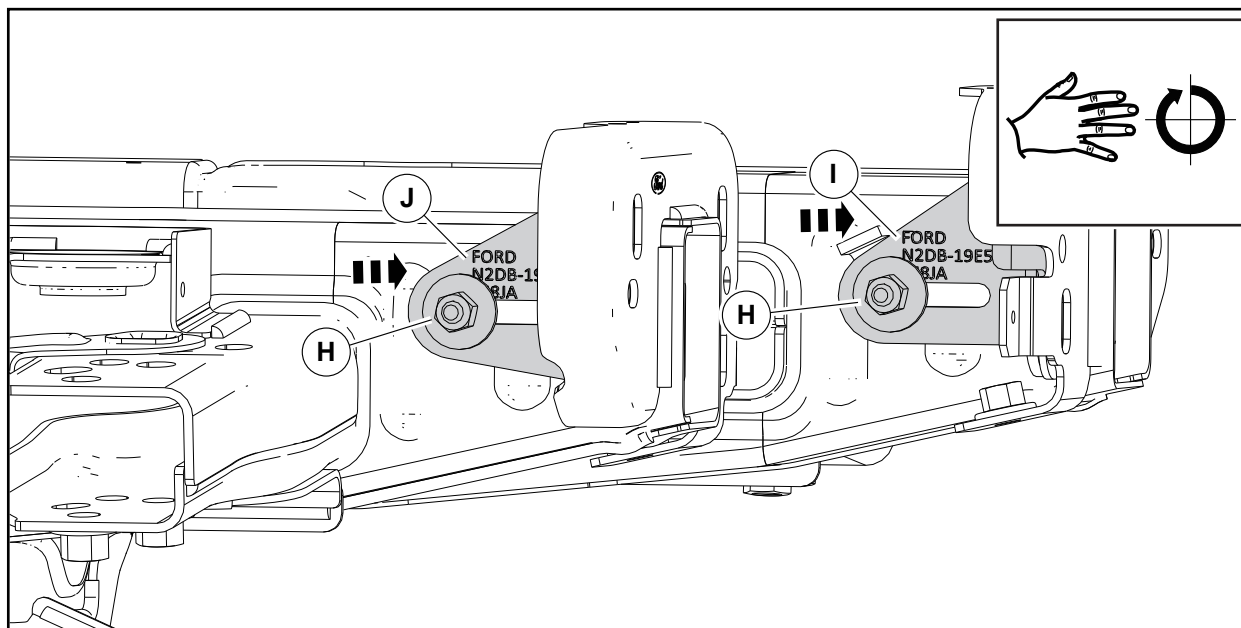

19. Install the frame rail bracket.

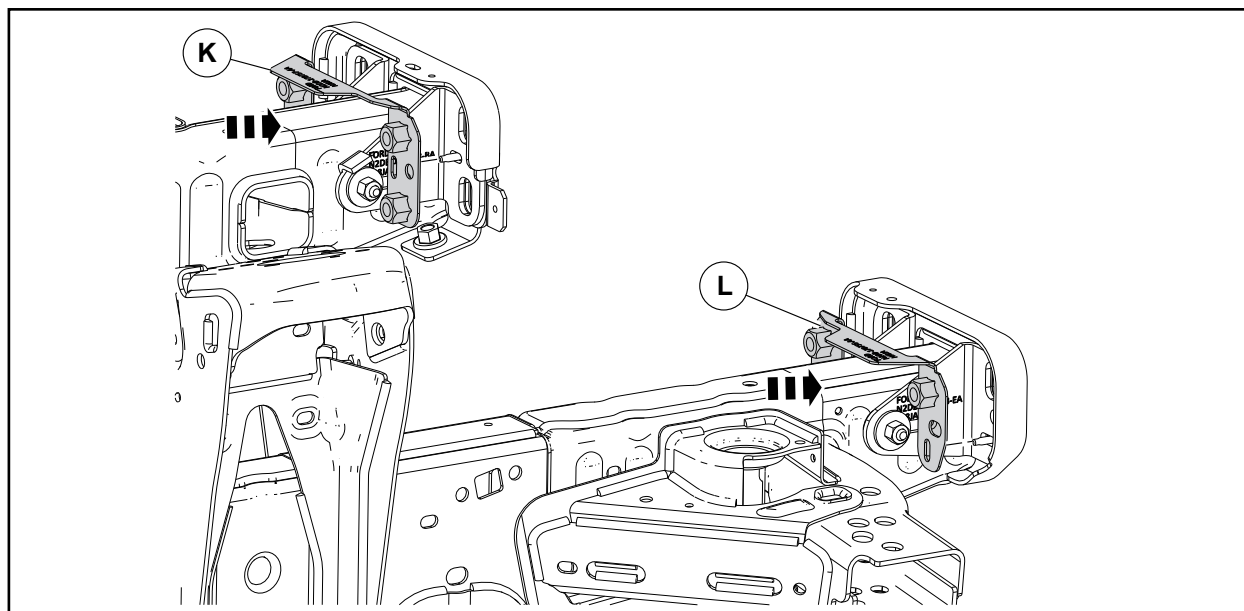

NO PART OF THIS DOCUMENT MAY BE REPRODUCED WITHOUT PRIOR AGREEMENT AND WRITTEN PERMISSION OF
FORD PERFORMANCE PARTS

20. Starting by hand, install the plastic holding nuts. Perform this step on both sides.

- Torque: 10 Nm (7 ft-lb)

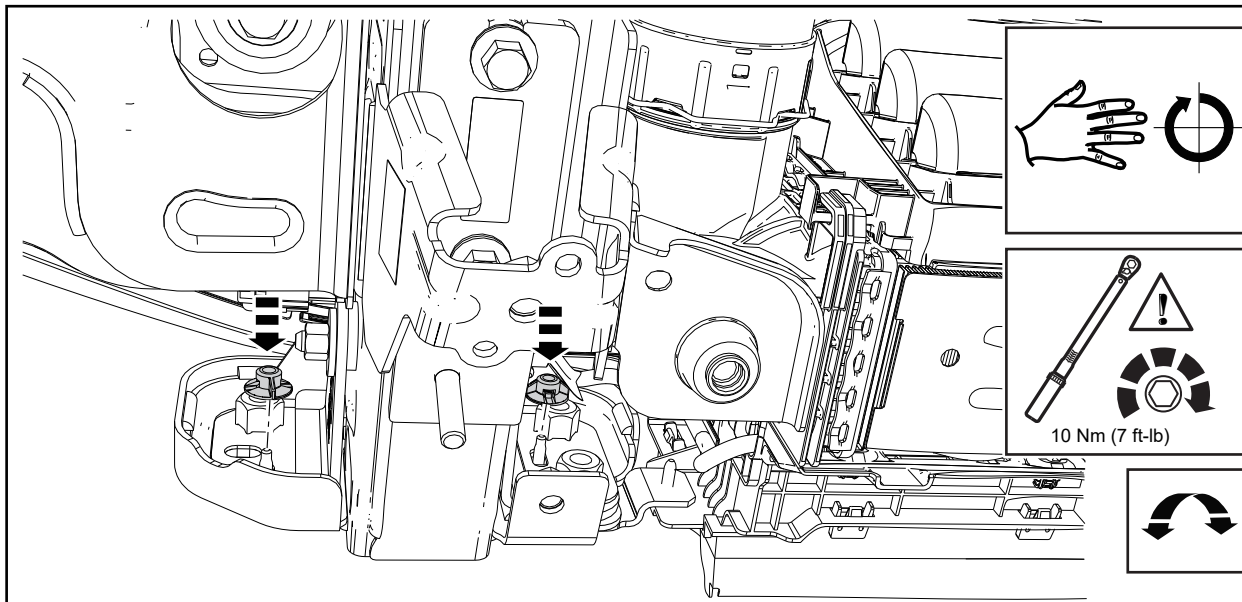

21. Tighten all 4 inner and outer brackets nuts.

- Torque: 48 Nm (35.5 ft-lb)

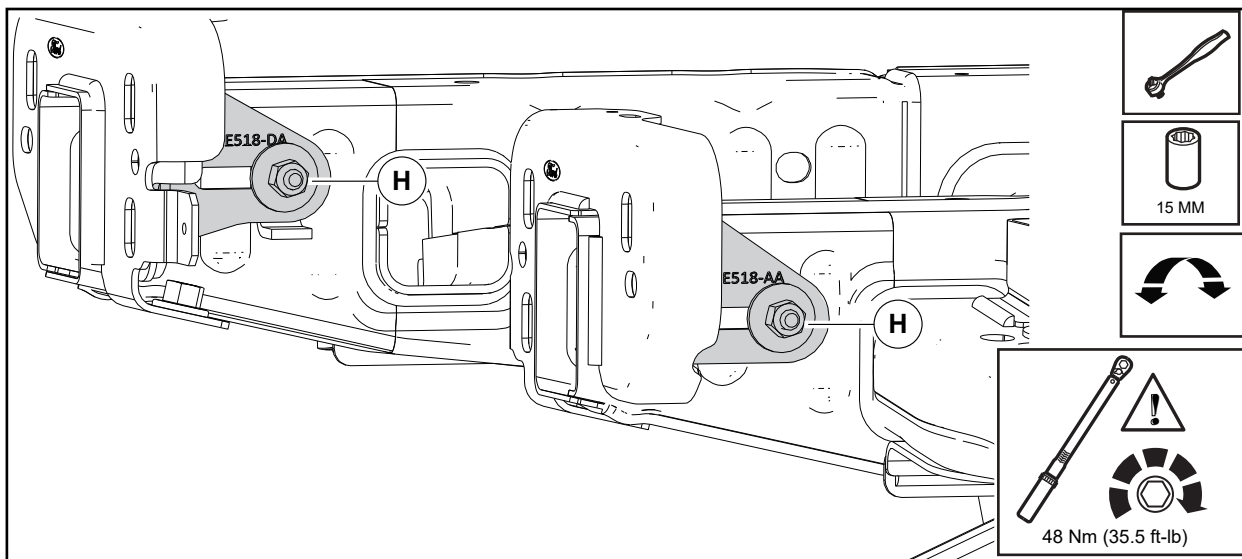

NO PART OF THIS DOCUMENT MAY BE REPRODUCED WITHOUT PRIOR AGREEMENT AND WRITTEN PERMISSION OF
FORD PERFORMANCE PARTS

22. Install the front bumper and connect the electrical connector.

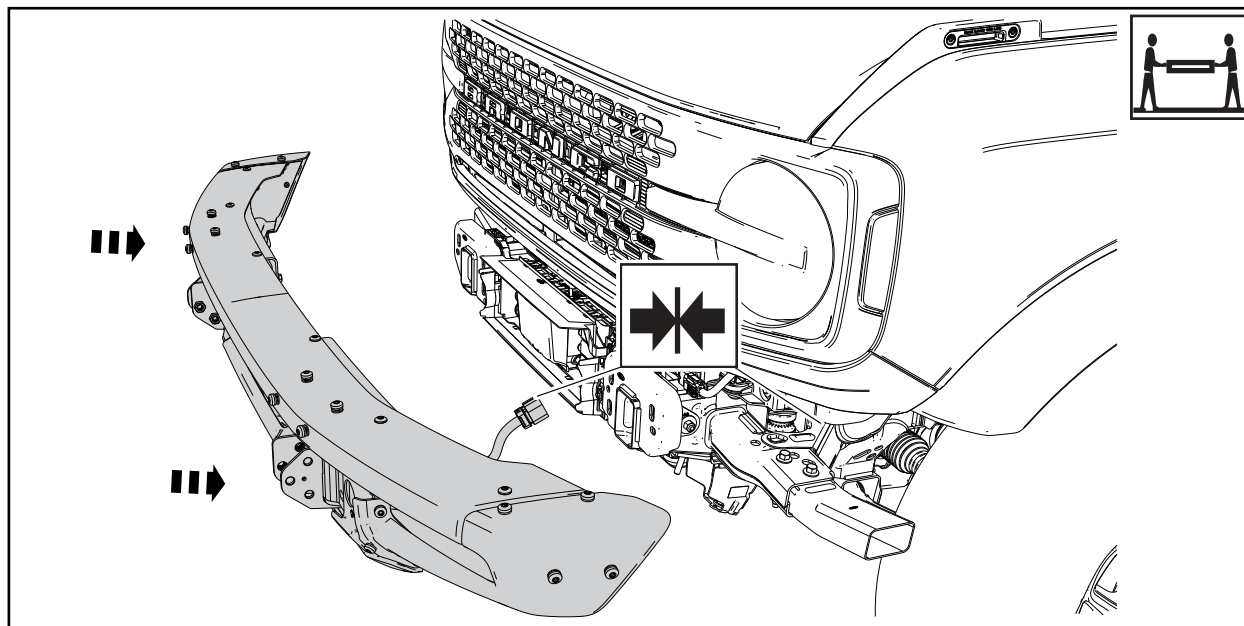

NOTE: Bolts saved from step 6.

23. Install the front bumper retainers.

- Torque: 80 Nm (59 ft-lb)

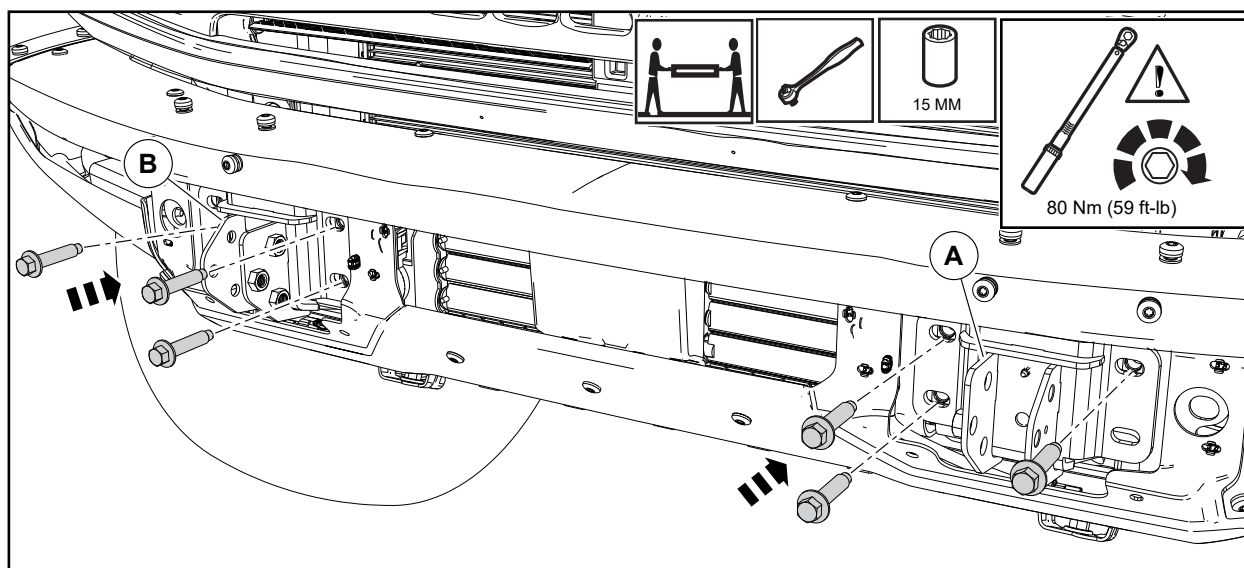

NO PART OF THIS DOCUMENT MAY BE REPRODUCED WITHOUT PRIOR AGREEMENT AND WRITTEN PERMISSION OF
FORD PERFORMANCE PARTS

24. Install the clevis bracket nuts.

- Torque: 35 Nm (25.8 ft-lb)

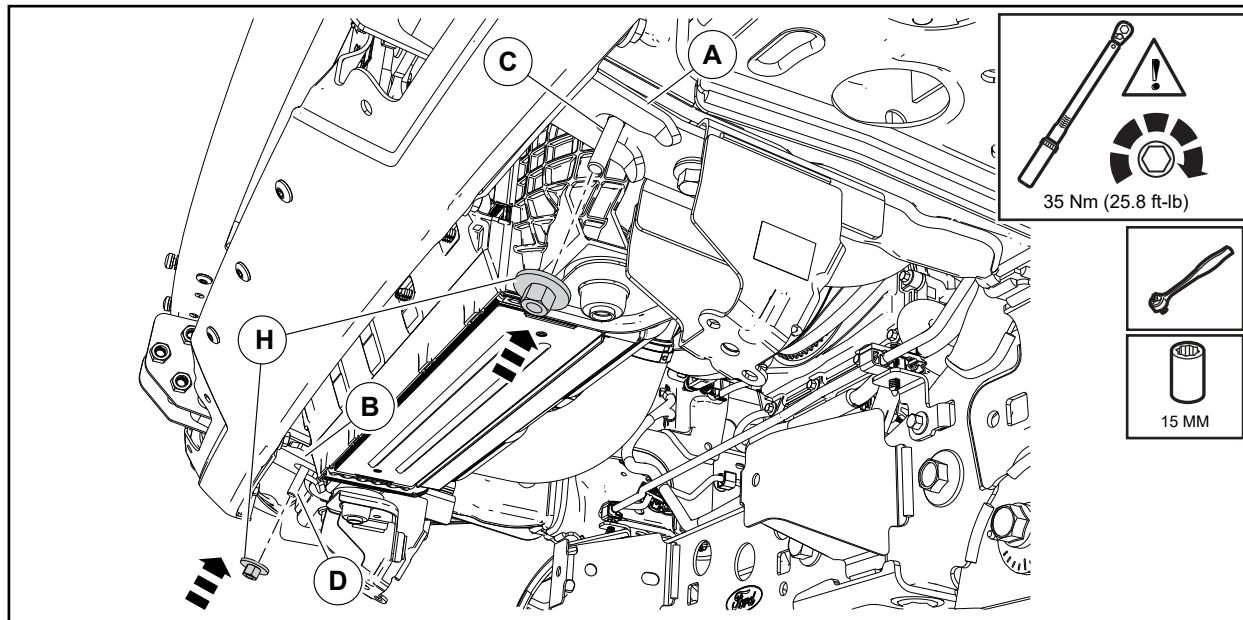

25. Install the recover forging into the clevis bracket.

- Torque: 110 Nm (81 ft-lb)

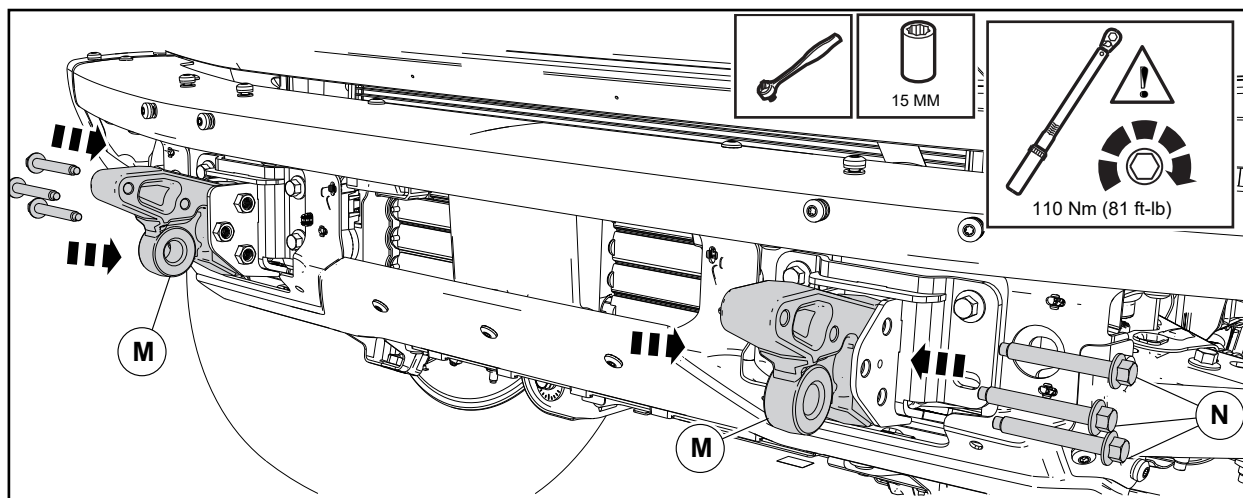

NO PART OF THIS DOCUMENT MAY BE REPRODUCED WITHOUT PRIOR AGREEMENT AND WRITTEN PERMISSION OF
FORD PERFORMANCE PARTS

26. Install the front bumper trim panels.

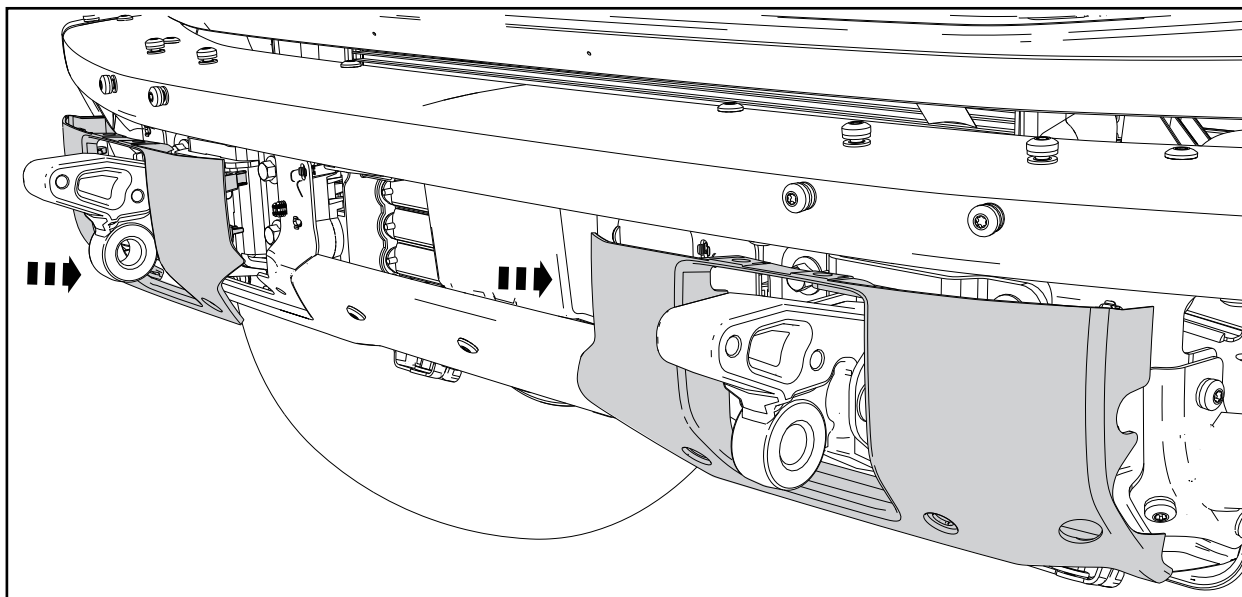

27. Install the front bumper trim panel push pins.

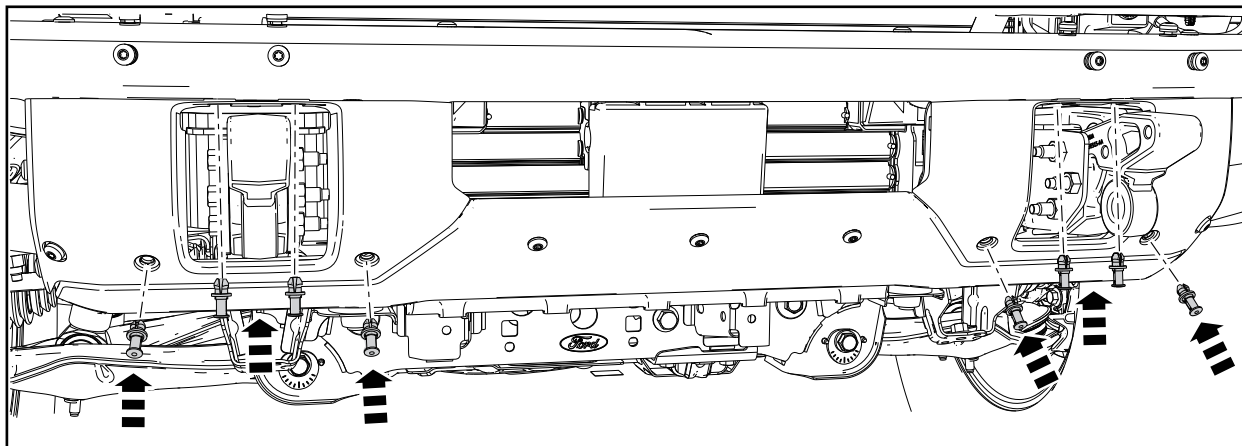

NO PART OF THIS DOCUMENT MAY BE REPRODUCED WITHOUT PRIOR AGREEMENT AND WRITTEN PERMISSION OF
FORD PERFORMANCE PARTS

28. Install the recovery forging mounting bracket.

- Torque: 80 Nm (59 ft-lb)

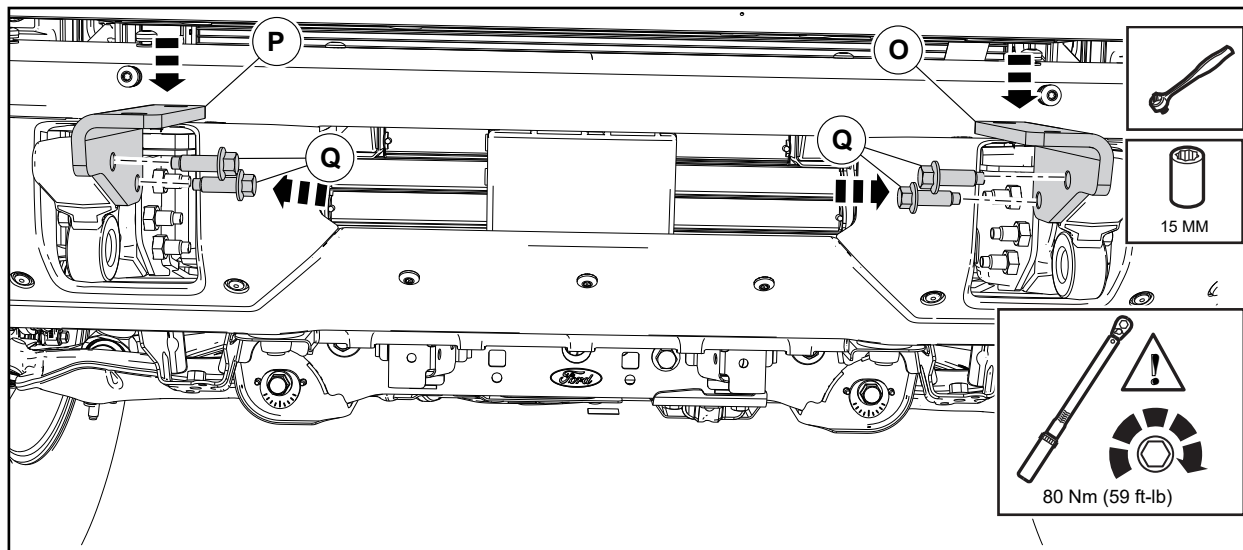

NOTE: Installation of license plate bracket is optional depending on local regulations.

29. Install the fairlead to the winch plate.

- Torque: 47.5 Nm (35 ft-lb)

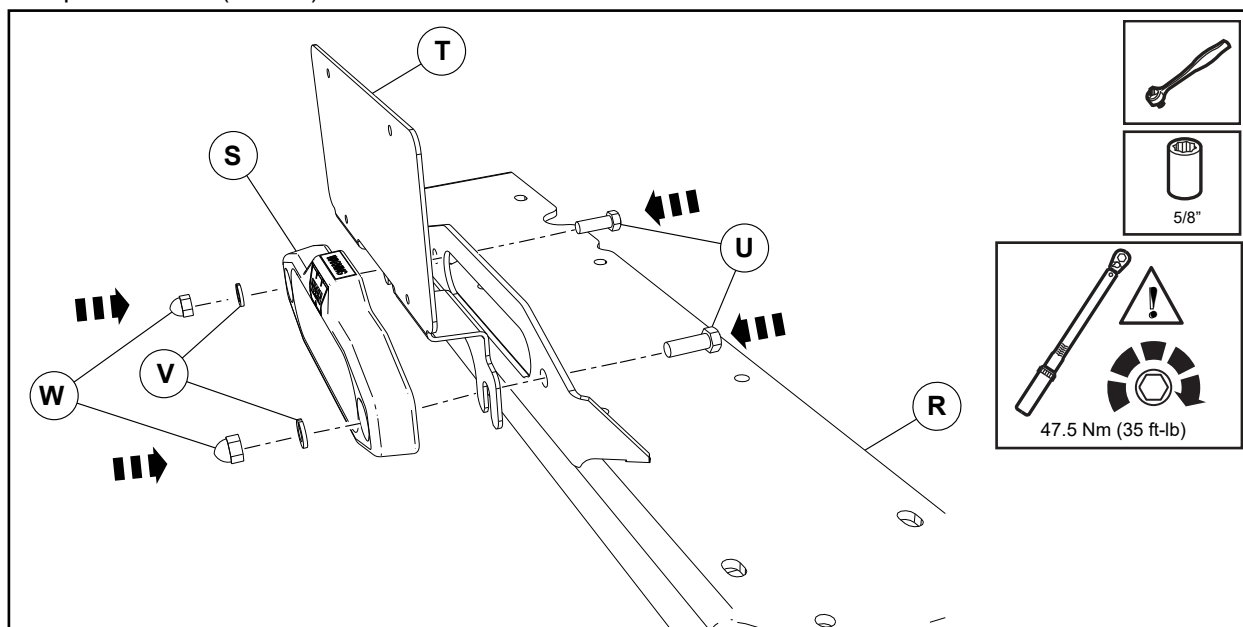

NO PART OF THIS DOCUMENT MAY BE REPRODUCED WITHOUT PRIOR AGREEMENT AND WRITTEN PERMISSION OF FORD PERFORMANCE PARTS

30. If equipped, install the license plate to license plate mounting bracket retainers.

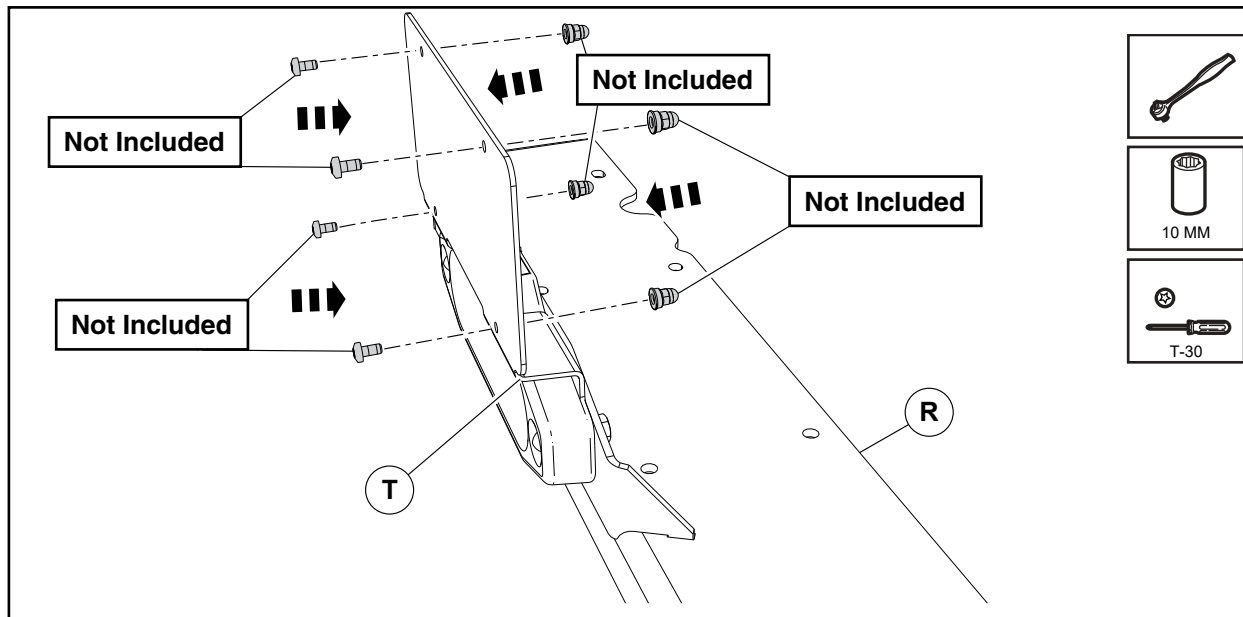

31. Install the winch mounting nuts into the winch housing slots.

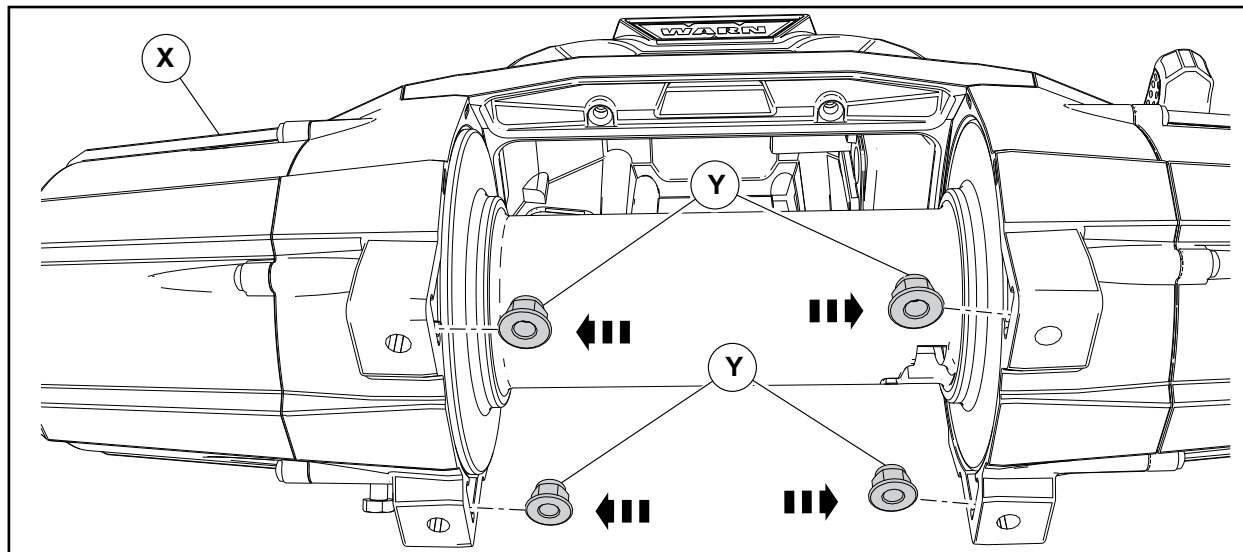

NO PART OF THIS DOCUMENT MAY BE REPRODUCED WITHOUT PRIOR AGREEMENT AND WRITTEN PERMISSION OF
FORD PERFORMANCE PARTS

32. Route the winch rope through the fairlead and install the winch to the winch plate.

• Torque: 47.5 Nm (35 ft-lb)

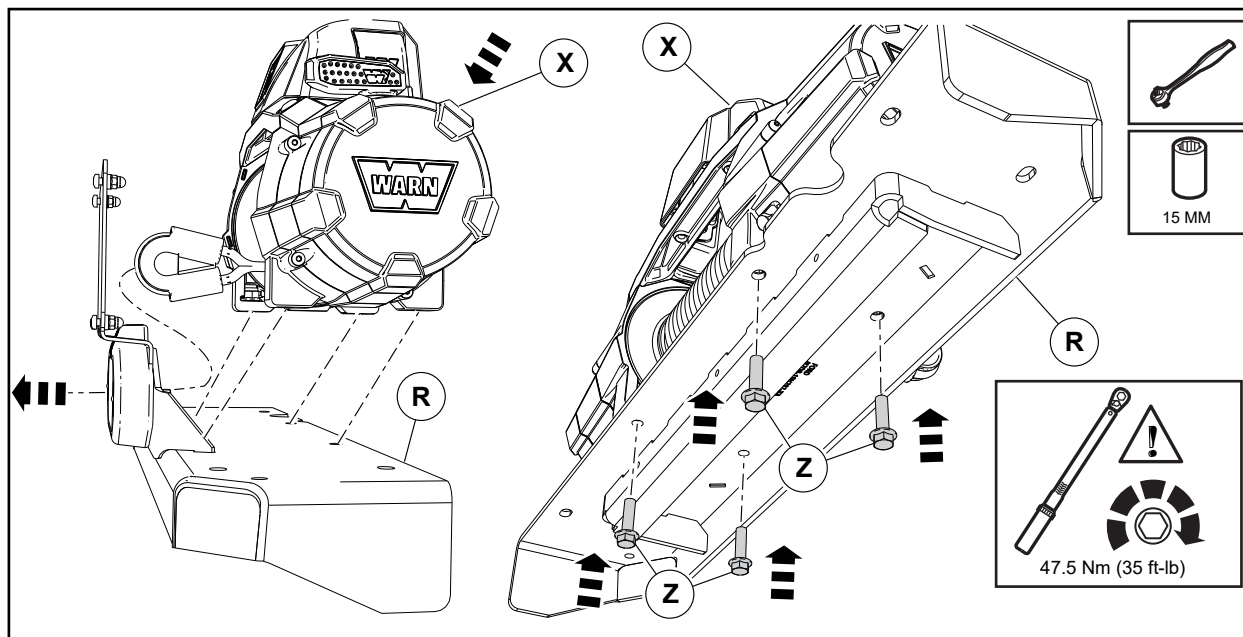

33. Engage the winch wire harness push pin retainers into the winch plate.

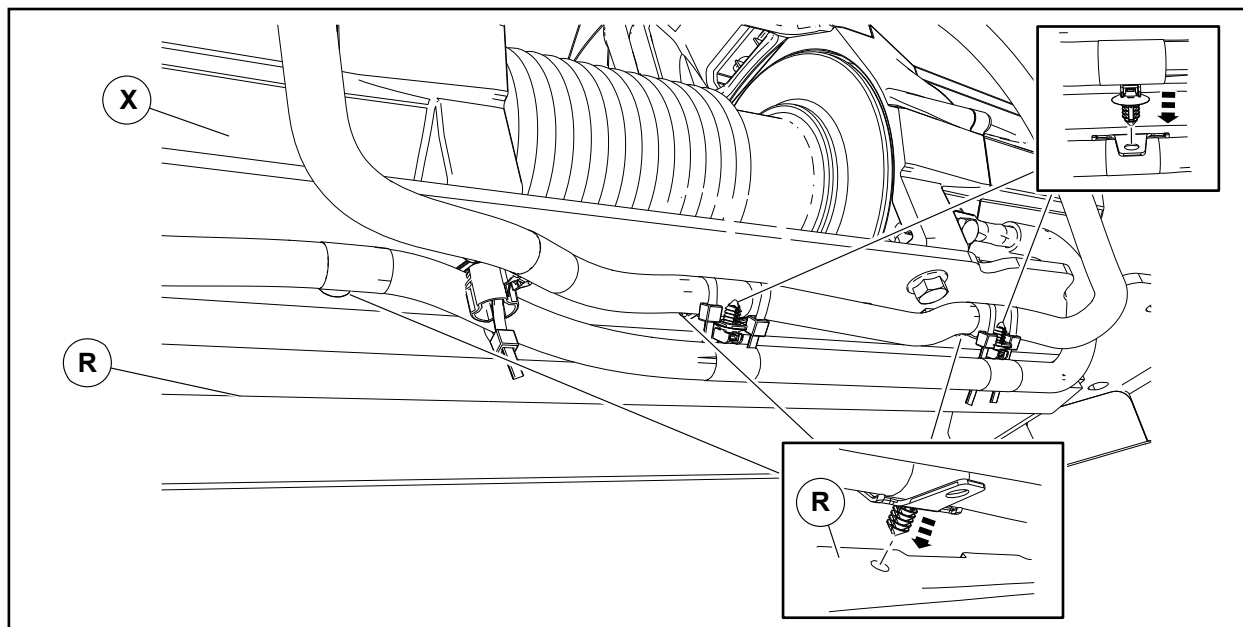

NO PART OF THIS DOCUMENT MAY BE REPRODUCED WITHOUT PRIOR AGREEMENT AND WRITTEN PERMISSION OF
FORD PERFORMANCE PARTS

34. Install the brush bar to the winch plate.

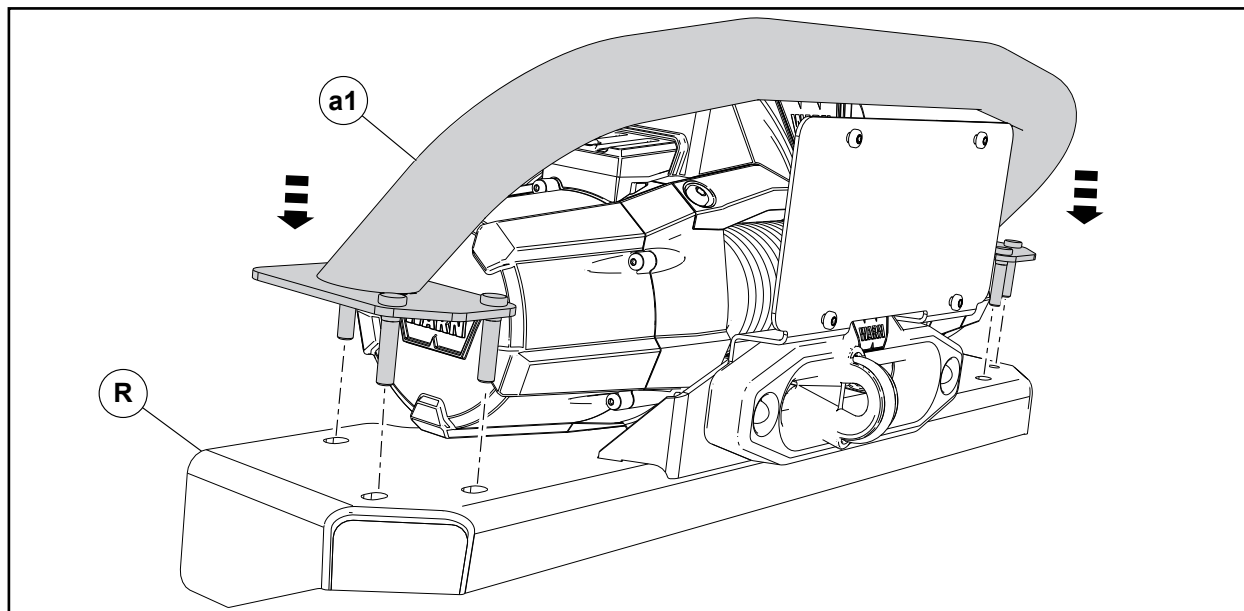

35. Install the brush bar outboard nut.

• Torque: 47.5 Nm (35 ft-lb)

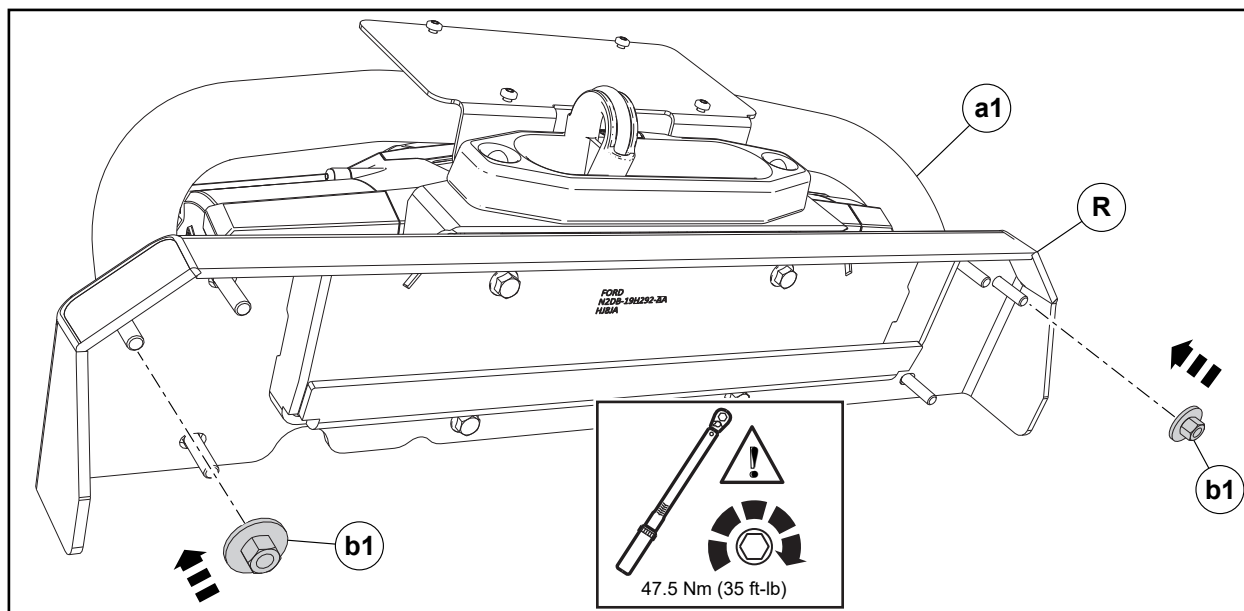

NO PART OF THIS DOCUMENT MAY BE REPRODUCED WITHOUT PRIOR AGREEMENT AND WRITTEN PERMISSION OF
FORD PERFORMANCE PARTS

36. Install the winch assembly to the recovery forging mounting brackets.

- Torque: 47.5 Nm (35 ft-lb)

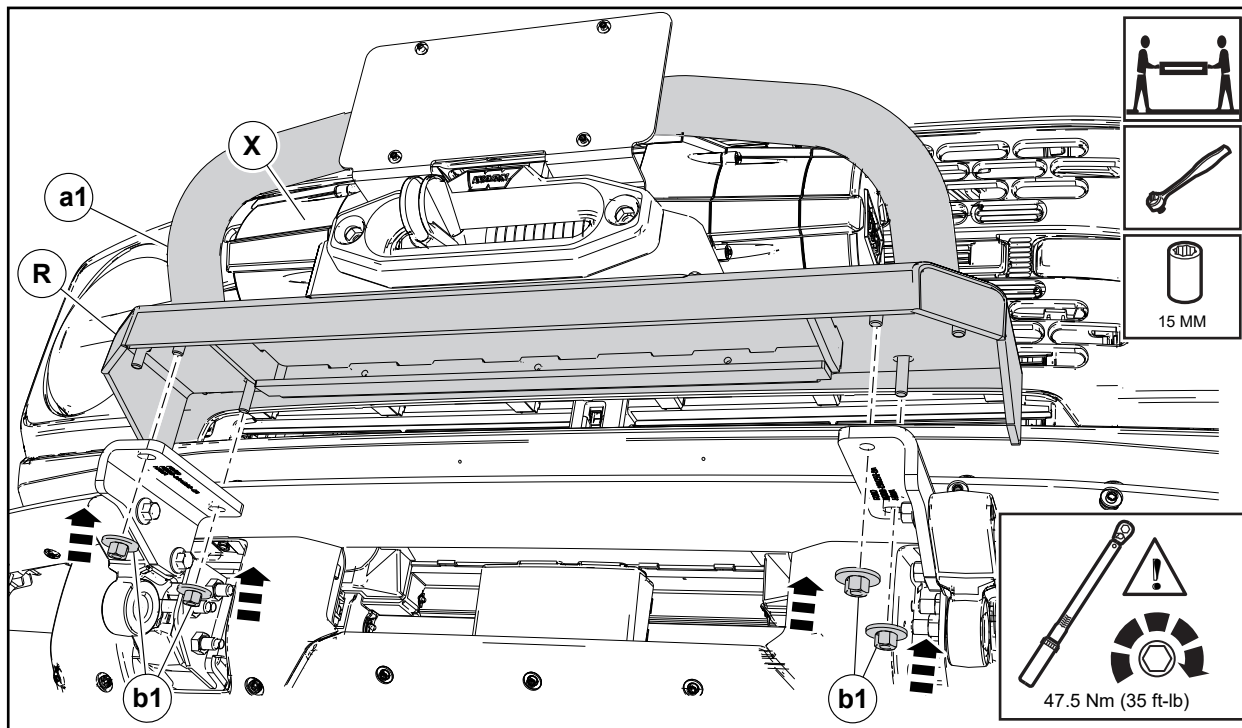

37. Remove the lug nuts and the left hand tire.

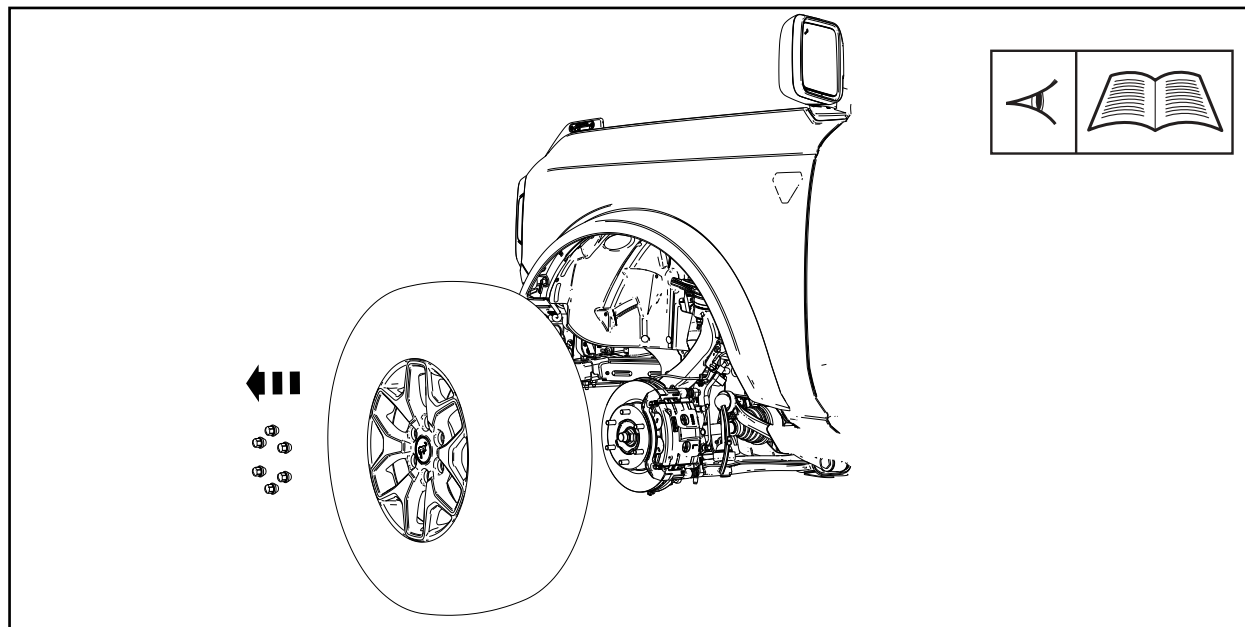

NO PART OF THIS DOCUMENT MAY BE REPRODUCED WITHOUT PRIOR AGREEMENT AND WRITTEN PERMISSION OF
FORD PERFORMANCE PARTS

38. Remove the retainers and the left hand wheel well splash shield.

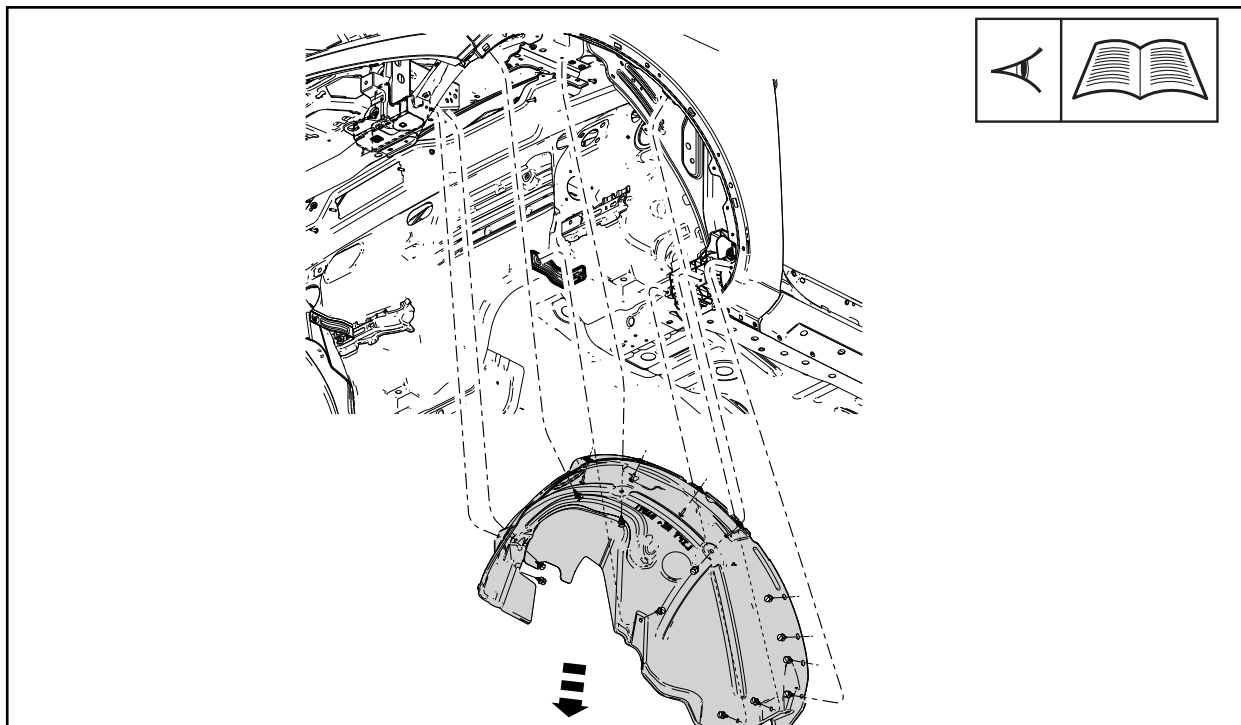

39. Route the positive battery cable under the winch plate and through the left hand side of the center bumper opening. Route the negative cable over top of the left hand recovery forging.

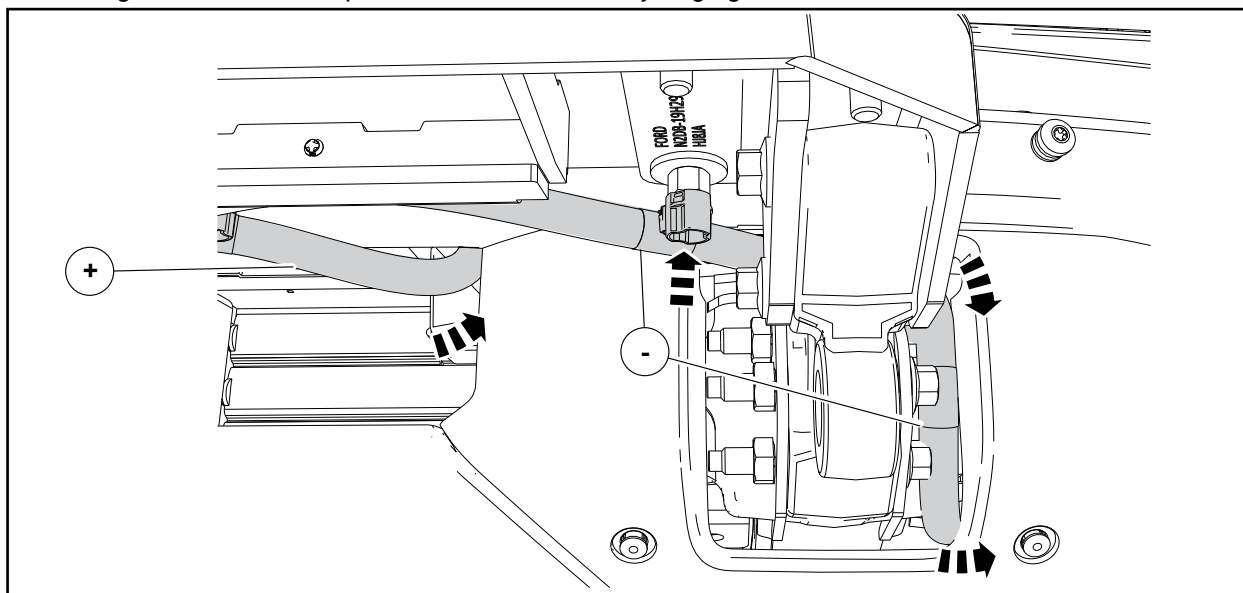

NO PART OF THIS DOCUMENT MAY BE REPRODUCED WITHOUT PRIOR AGREEMENT AND WRITTEN PERMISSION OF
FORD PERFORMANCE PARTS

40. Route the positive cable through the frame towards the left hand side of the vehicle.

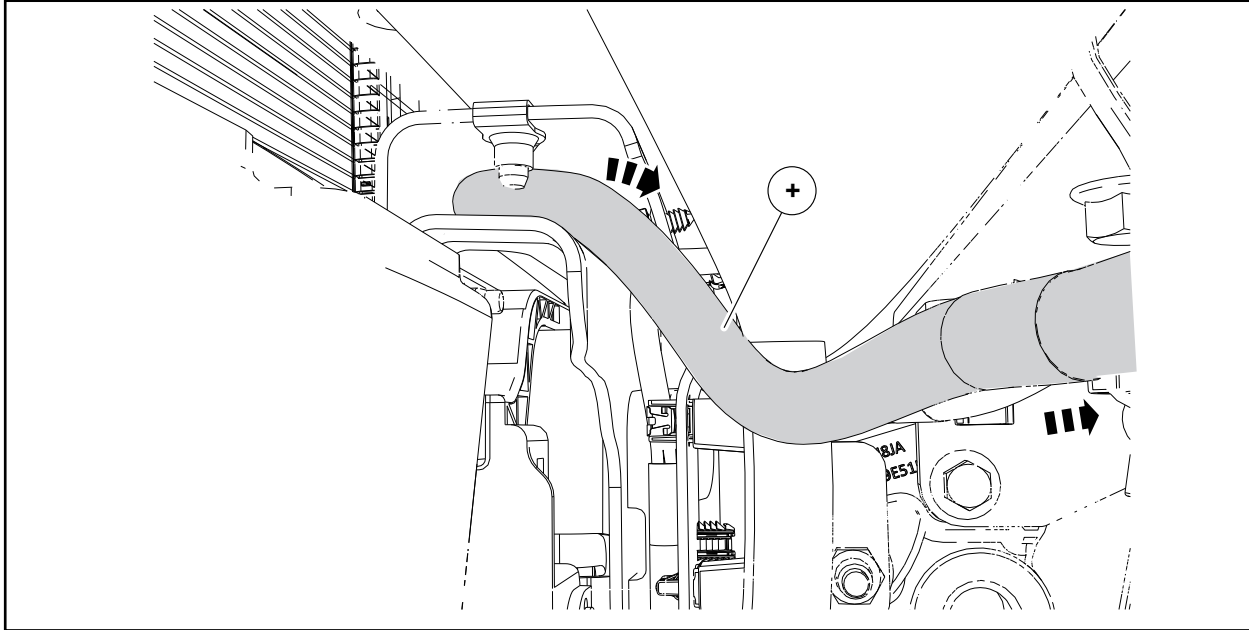

NO PART OF THIS DOCUMENT MAY BE REPRODUCED WITHOUT PRIOR AGREEMENT AND WRITTEN PERMISSION OF
FORD PERFORMANCE PARTS

41. Route the positive and negative cables upwards towards the battery. Secure the cables to the existing wiring harness using tie straps.

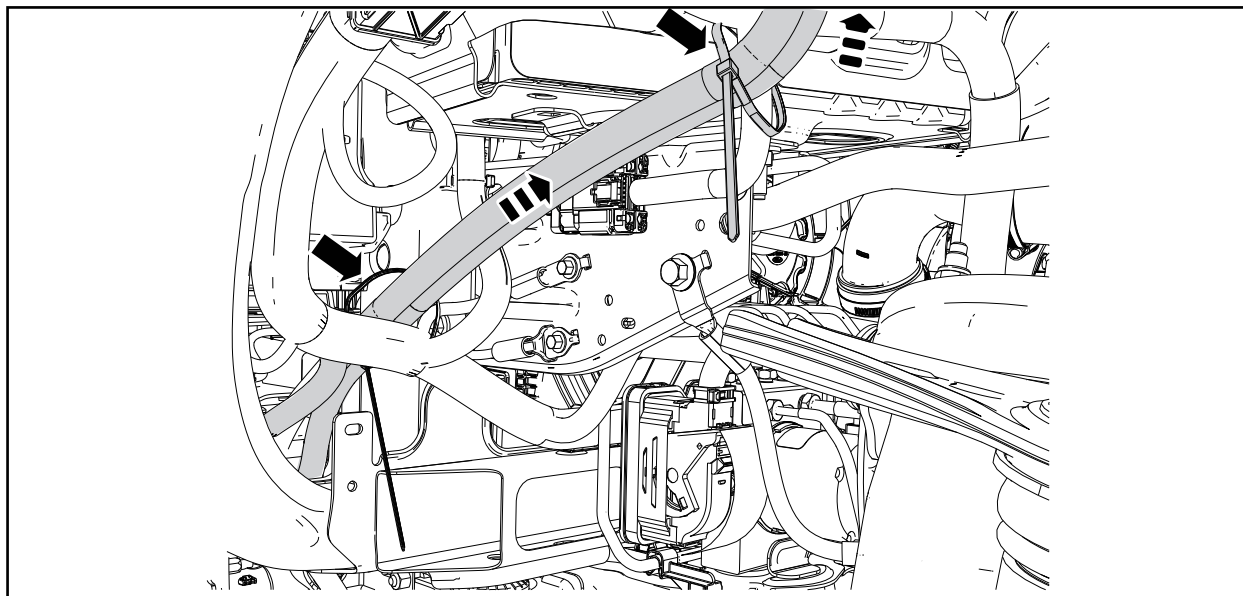
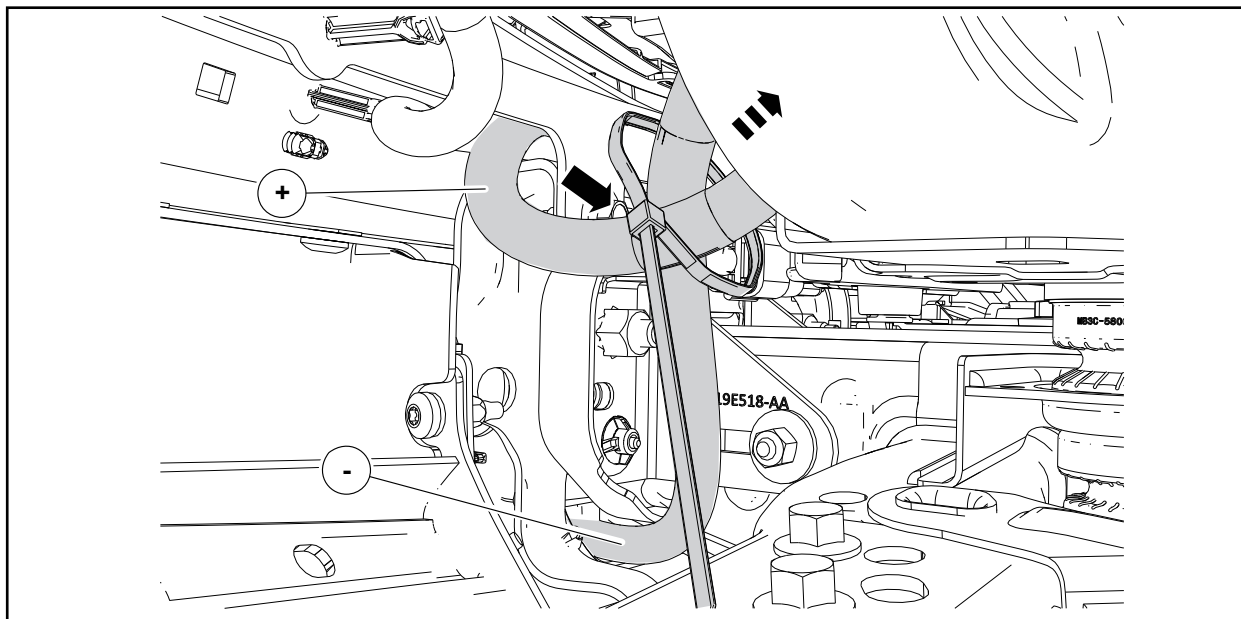

NO PART OF THIS DOCUMENT MAY BE REPRODUCED WITHOUT PRIOR AGREEMENT AND WRITTEN PERMISSION OF
FORD PERFORMANCE PARTS

42. Open the hood of the vehicle.

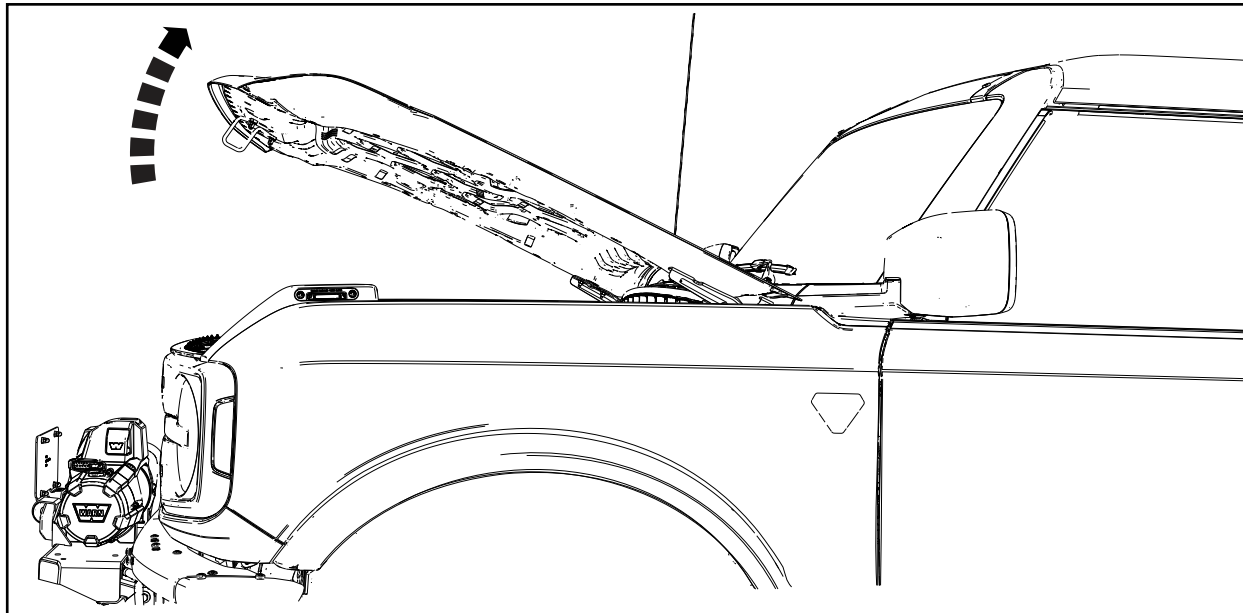

43. Connect the positive winch cable to the positive bus bar on the vehicles battery.

• Torque: 13.5 Nm (10 ft-lb)

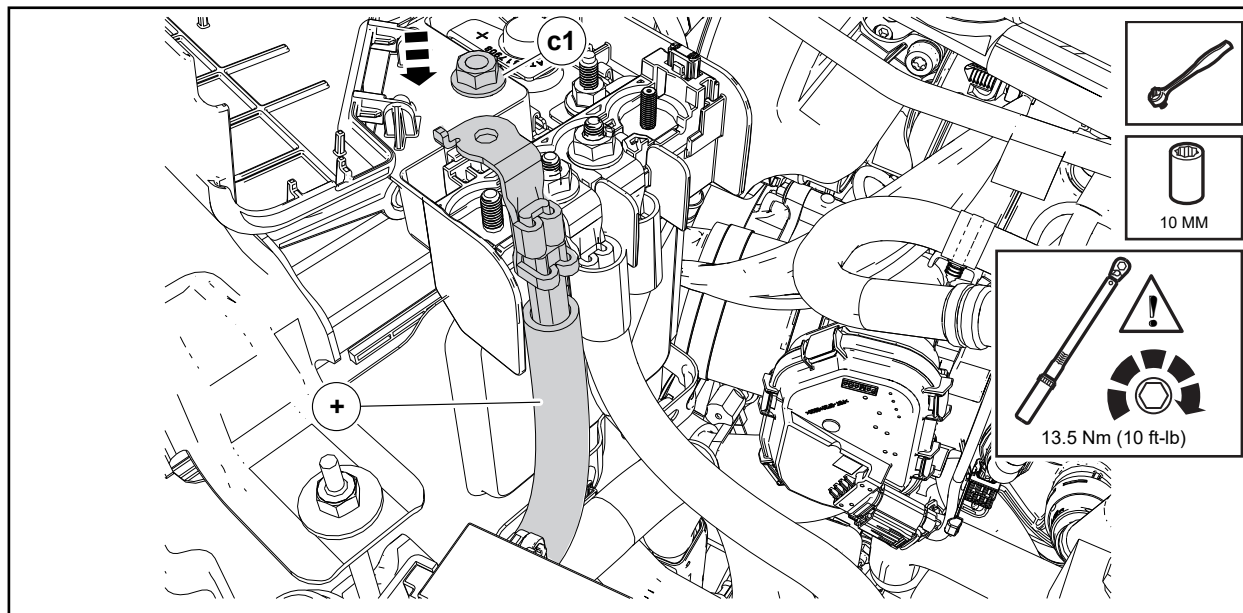

NO PART OF THIS DOCUMENT MAY BE REPRODUCED WITHOUT PRIOR AGREEMENT AND WRITTEN PERMISSION OF
FORD PERFORMANCE PARTS

44. Connect the negative winch cable to the negative terminal on the vehicles battery.

- Torque: 13.5 Nm (10 ft-lb)

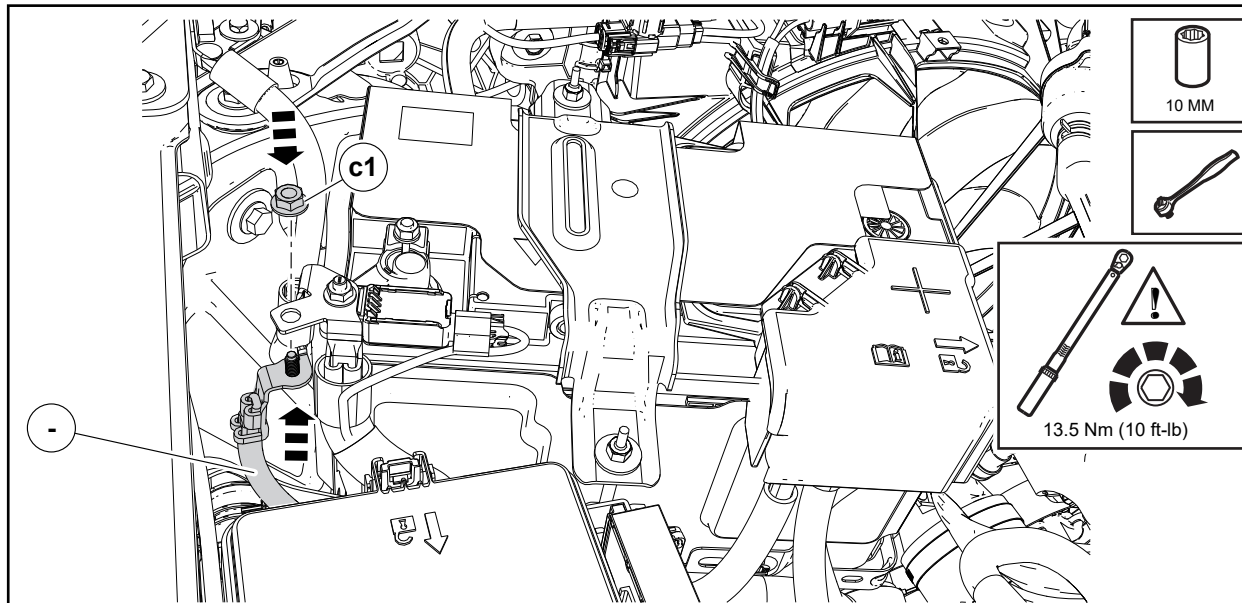

45. Install the tow hook and tow hook strap to the winch cable eyelet.

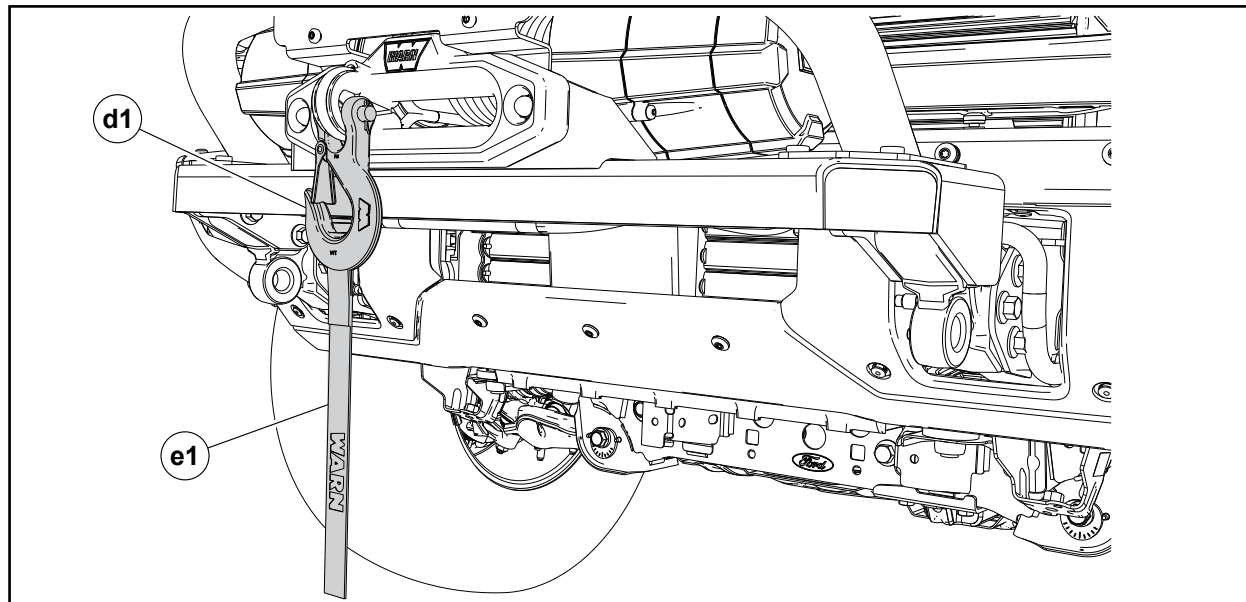

NO PART OF THIS DOCUMENT MAY BE REPRODUCED WITHOUT PRIOR AGREEMENT AND WRITTEN PERMISSION OF FORD PERFORMANCE PARTS

46. Connect the remote to the winch and test the operation. Store the winch remote in the center console.

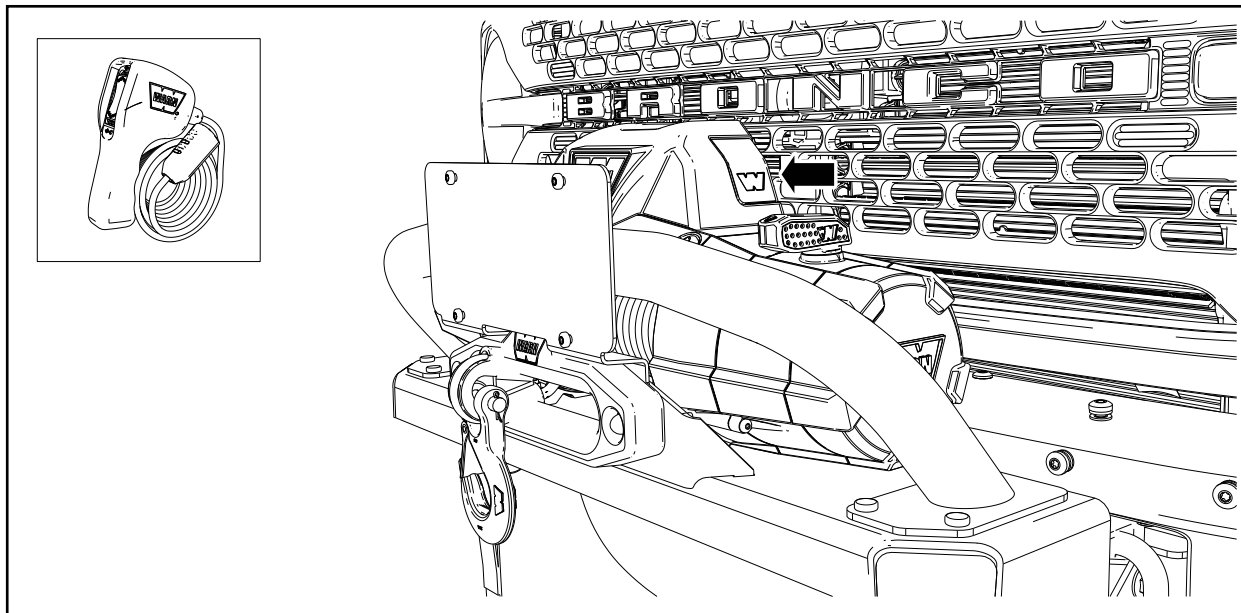

47. Close the hood of the vehicle.

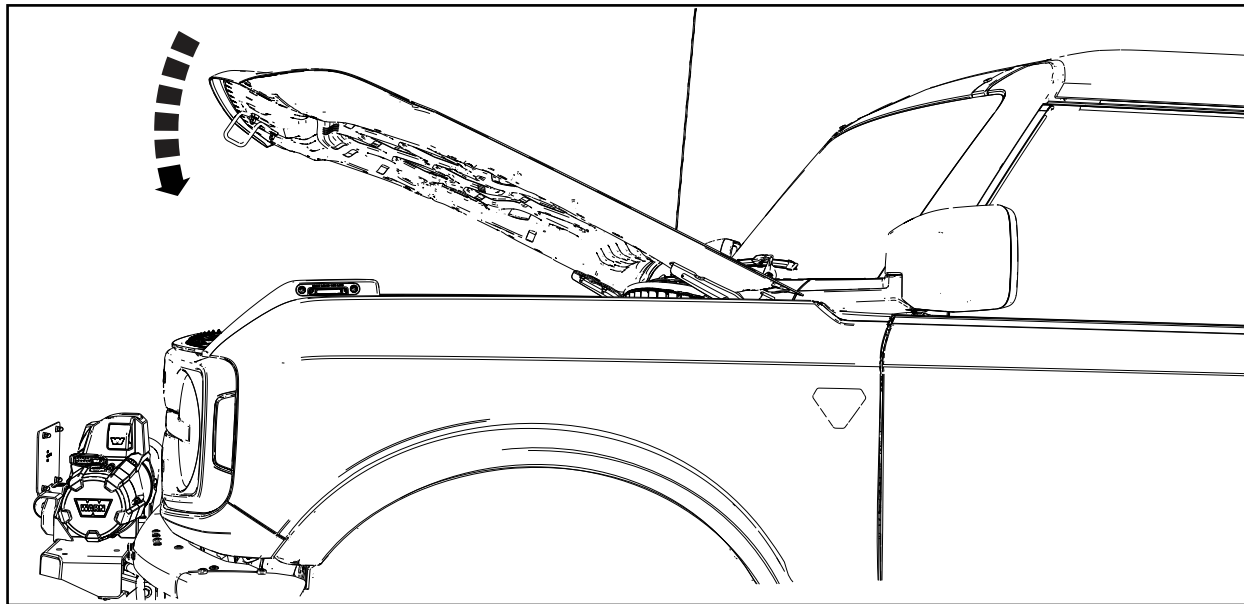

NO PART OF THIS DOCUMENT MAY BE REPRODUCED WITHOUT PRIOR AGREEMENT AND WRITTEN PERMISSION OF
FORD PERFORMANCE PARTS

48. Install the left hand wheel well splash shield and retainers.

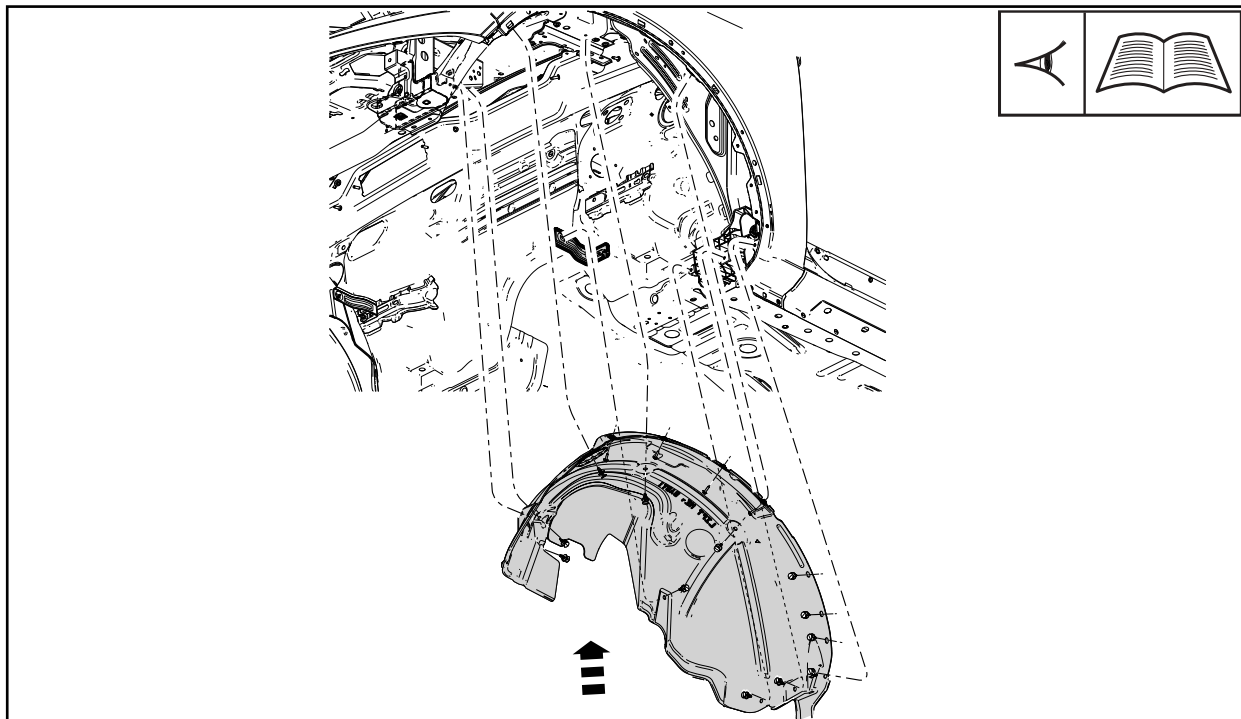

49. Install the left hand tire and lug nuts.

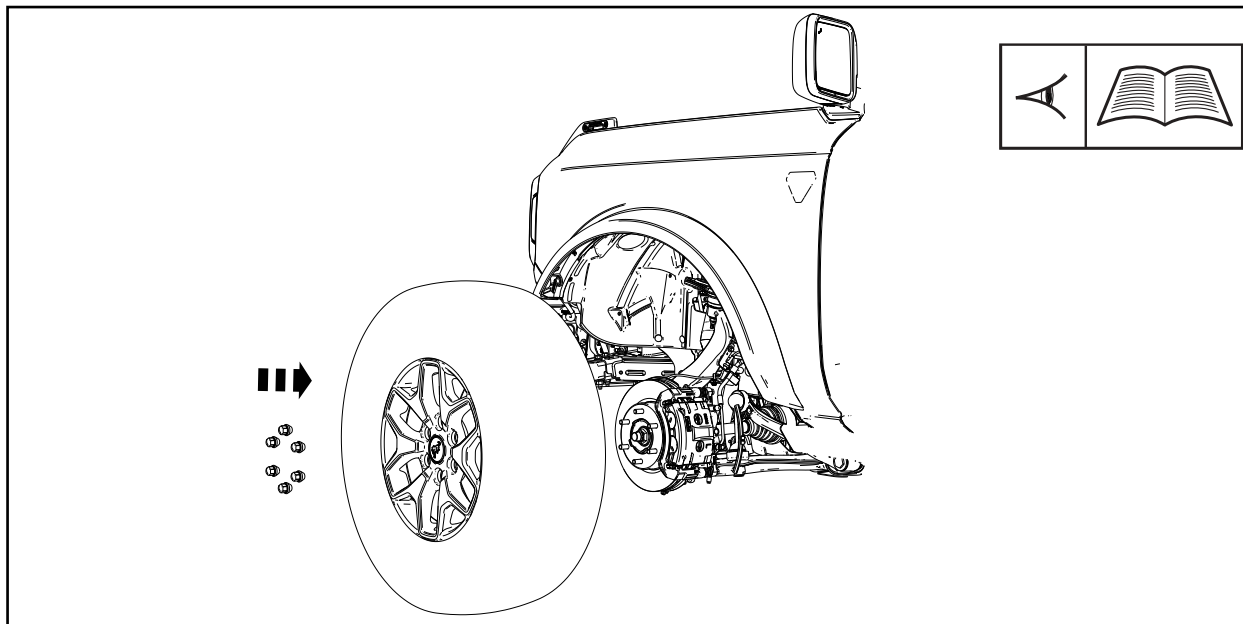

NO PART OF THIS DOCUMENT MAY BE REPRODUCED WITHOUT PRIOR AGREEMENT AND WRITTEN PERMISSION OF FORD PERFORMANCE PARTS

50. Install the left hand wheel well splash shield and retainers.

• Torque: 30 Nm (22 ft-lb)

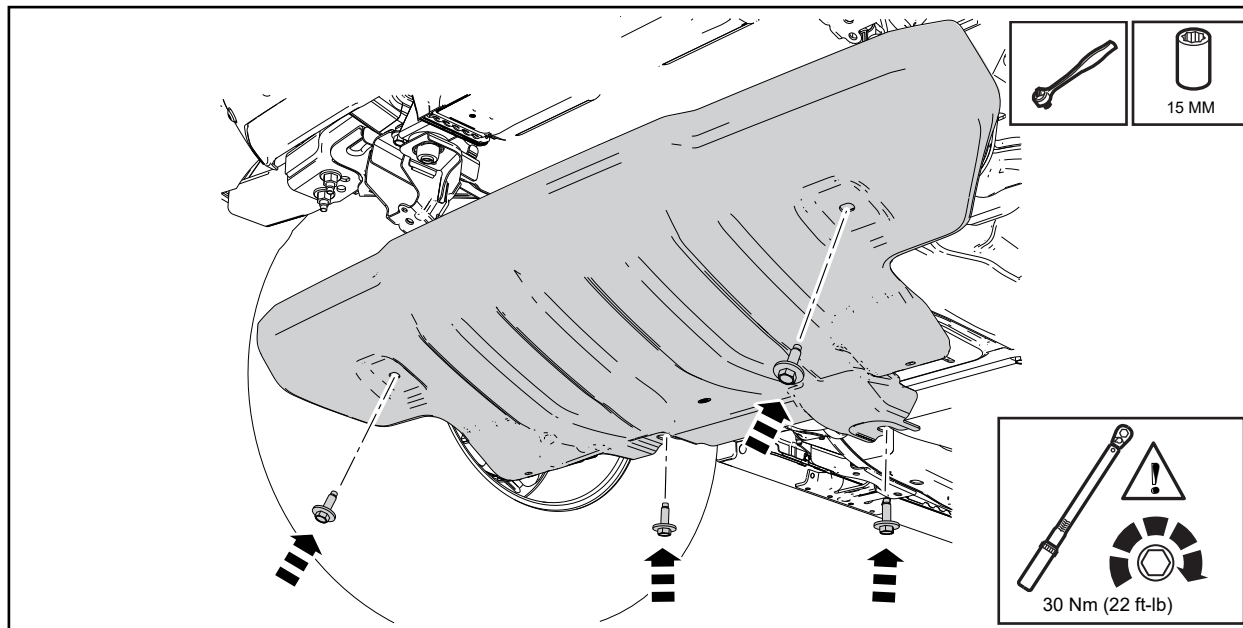

Programming procedure:

51. Connect Ford Diagnostic & Repair System (FDRS) and start a new vehicle session.



52. Select "Toolbox", then scroll down to "RCM - Restraint Control Module". On the left hand side of the screen download the "RCM - Winch Configuration"

53. Select "Run" after the download has completed. Follow the on-screen instructions to complete the RCM - Winch Configuration.

NOTE: When prompted for part number entry, enter "M-1821". The part numbers are case sensitive. Do Not enter spaces or a part suffix or quotes.

54. If equipped with Front Bumper Park Aid Sensors, disable Park Aid Front Sensors. Press 'Features' on the SYNC touchscreen, press 'Driver Assistance', then select 'Park Aid Front Sensors' to OFF.



M-1821-B
2021 →
Bronco Off-Road Winch

NO PART OF THIS DOCUMENT MAY BE REPRODUCED WITHOUT PRIOR AGREEMENT AND WRITTEN PERMISSION OF
FORD PERFORMANCE PARTS

Returning Vehicle to Factory Condition:

When completely removing the Winch from the vehicle, perform these steps to return the vehicle to factory conditions. Programming is required to reset the airbag safety system sensitive for proper deployment during a collision event.

55. Connect Ford Diagnostic & Repair System (FDRS) and start a new vehicle session.
56. Select "Toolbox", then scroll down to "RCM - Restraint Control Module". On the left hand side of the screen download the "RCM - Winch Configuration"
57. Select "Run" after the download has completed. Then select "Remove Winch from Vehicle" and follow the on-screen instructions to complete the RCM – Winch Configuration.

NOTE: During the programming procedure you will be prompted to enter the part number "**RESTORE**". The part numbers are case sensitive and do not include any spaces.

58. If equipped with Front Bumper Park Aid Sensors, Enable Park Aid Front Sensors. Press 'Features' on the SYNC touchscreen, press 'Driver Assistance', then select 'Park Aid Front Sensors' to ON.