



**M-5220-3VMB  
2005 / 2010 Mustang Quad Exhaust  
INSTALLATION INSTRUCTIONS**

Please visit [www.fordracingparts.com](http://www.fordracingparts.com) for the most current instruction information

**!!! PLEASE READ ALL OF THE FOLLOWING INSTRUCTIONS CAREFULLY PRIOR TO  
INSTALLATION.**

**AT ANY TIME YOU DO NOT UNDERSTAND THE INSTRUCTIONS, PLEASE CALL THE FORD RACING  
TECHLINE AT 1-800-367-3788 !!!**

## **OVERVIEW:**

***The use of a floor hoist is recommended for this installation. If you do not have access to one, use a hydraulic floor jack and jack stands to raise the vehicle.***

***!! CAUTION: JACK STANDS MUST BE USED ON A LEVEL SURFACE AND BE SECURELY SEATED. FAILURE TO DO SO MAY RESULT IN PERSONAL INJURY OR VEHICLE DAMAGE !!***

## **KIT INCLUDES:**

<b><u>Item #</u></b>	<b><u>Qty:</u></b>	<b><u>Description</u></b>
1	1	X-Pipe
2	2	Clamps
3	4	Bolts, X-pipe to side pipe
4	4	Nuts, X-pipe to side pipe
5	1	RH side pipe assembly w/support grommet installed
6	1	LH side pipe assembly w/support grommet installed
7	2	Bolts, side pipe to rocker
8	2	Nuts, side pipe to rocker (2005-09)
9	2	gaskets, side pipe to X-pipe

Factory Ford shop manuals are available from Helm Publications, 1-800-782-4356

## INSTALLATION INSTRUCTIONS:

**STEP 1:** Raise and support vehicle.

**STEP 2:** Spray penetrate on Exhaust coupler nuts. Loosen all Exhaust coupler nuts.  
(Number 1 in figure below.)

**NOTE:** 4.6L shown, 5.4L similar.

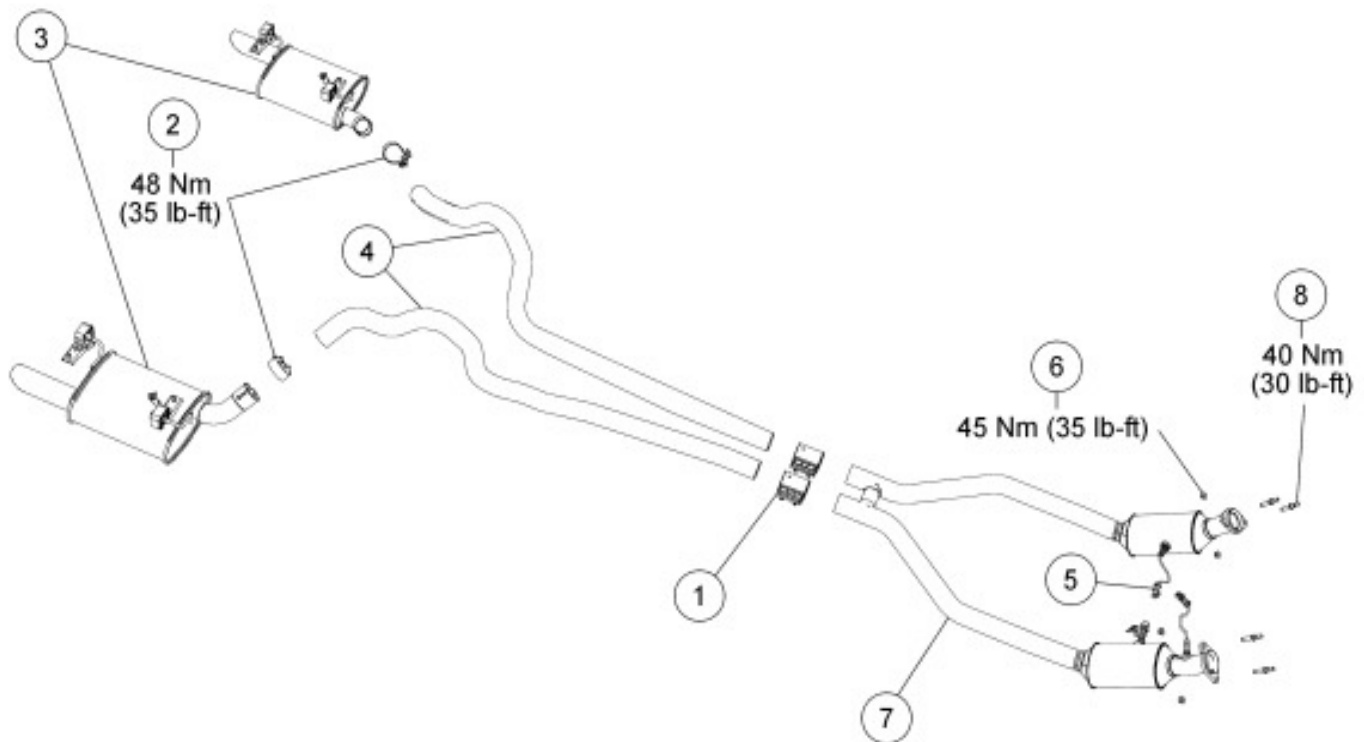

N0098789



**Fig. 3**



**Fig. 4**

**STEP 3:** Lift clamp tabs (See Fig. 3).

**STEP 4:** Slide both clamps toward rear of vehicle (See Fig. 4).

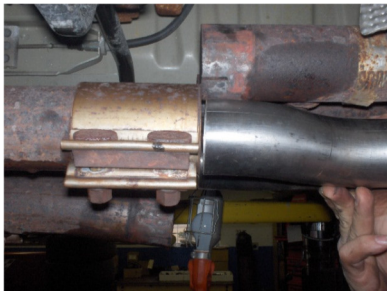

**Fig. 5**



**Fig. 6**



**Fig. 7**

**STEP 5:** Hold new X-pipe and align with rear of exhaust. Mark H-pipe with tape where X-pipe begins.  
(See Fig. 5, 6 & 7).



**Fig. 8**



**Fig. 9**



**Fig. 10**

**STEP 6:** Measure 1-1/2" back from end of H-pipe tape mark and make tape cut line (See Fig. 8).

**STEP 7:** Cut both pipes at cut line (See Fig. 9)

**STEP 8:** Clean sharp edges and burrs with a file (See Fig. 10)



**Fig. 11**

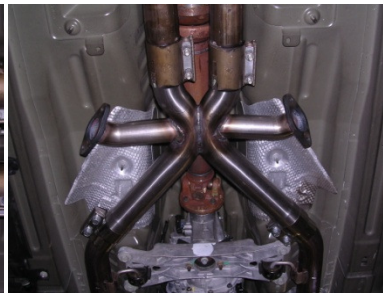

**Fig. 12**



**Fig. 13**

**STEP 9:** Slide new clamps on exhaust small end first (See Fig. 11, 12&13).

**STEP 10:** Install new X-pipe in place (See Fig. 12&13).

**STEP 11:** Slide new clamps over front connection and the original rear clamps over rear of pipes (See Fig. 12).

**STEP 12:** Tighten rear clamp bolts 54 Nm (40 lb-ft).

**STEP 13:** Tighten front clamp bolts 54 Nm (40 lb-ft).



**Step 14:** Remove LH and RH plastic shields in front of fuel tank from the underside of the vehicle.

### **Side Pipe Installation**

**STEP 15:** **NOTICE:** Do not bend, twist or allow the exhaust side pipes to hang from the flexible bellows or damage to the exhaust side pipe may occur.

**Step 16:** Loosely install side pipes to X-pipe using 2 bolts, 2 nuts and 1 gasket per side.

**Step 17:** Install side pipe outer support bolt (2009-2010) Tighten to 25 Nm (18 lb-ft).

**Note:** 2005-2008 do not have factory installed nut insert

**Step 18:** For 2005-2008 cars, move side pipe into position so side pipe outer support hole is centered on rocker and mark rocker to drill hole. Hole will be rearward of the oblong hole in rocker

**Step 19:** Using a .550 diameter drill, drill hole through rocker. Paint raw metal with a rust preventive paint.

**Step 20:** Insert nut through oblong hole in rocker and position over the hole you drilled.



**Step 21:** While holding nut in place, insert outer support bolt through side pipe grommet assembly and start outer support bolt using fingers. Once the bolt engages the self-locking feature of the nut, continue tightening with ratchet.

**Step 22:** Tighten the LH and RH exhaust side pipe bolts to 18 lb-ft

**NOTE:** Verify that the Torca® clamp has a clearance of 10 mm (0.393 in) to 19 mm (0.748 in) to the flat surface of the floor pan. Adjust as necessary

**Step 23:** Tighten the exhaust side pipe-to-exhaust H-pipe nuts to 40 Nm (30 lb-ft).

**NOTE:** Make sure the flat section of the side pipes has a clearance of 14 mm (0.551 in) to 23 mm (0.905 in) to the floor pan. If the exhaust side pipe Torca® clamps have to be loosened to adjust clearance, tighten to 35lb-ft

Restrictors can be purchased from the Ford dealer, part number CR3Z-5C226-A and installed for a quieter exhaust note.



**M-5220-3VMB**  
**2005 / 2010 Mustang Quad Exhaust**  
**INSTALLATION INSTRUCTIONS**

Factory Ford shop manuals are available from Helm Publications, 1-800-782-4356



**M-5220-3VMB**  
**2005 / 2010 Mustang Quad Exhaust**  
**INSTALLATION INSTRUCTIONS**

Factory Ford shop manuals are available from Helm Publications, 1-800-782-4356